

NOTICE!!

These documents have been scanned!

Do not place un-scanned documents beneath this notice!

Do not remove this notice from this file!

GPO Jacket No. 560-102
Print Order 61540
Rise Business Services, LLC
Job=AZ15 6/6/2019



Box Number= AZ15122



Claim Begin-End: AMC358030-AMC358031

1 Initial Receipt



AZ15122-6

AMC357873-AMC358493

**United States Department of the Interior
Bureau of Land Management**

BUSINESS & SUPPORT SVCS DIV
222 N CENTRAL AVE
PHOENIX, AZ 85004 -2203
Phone: (602) 417-9200

Receipt	
No:	1127311

Transaction #: 1166316
Date of Transaction: 08/12/2005

ENTERED INTO COMPUTER
AUG 18 2005 *pb*

CUSTOMER: SILVER KING MINING CO OF AZ
56389 E SIMMONS WAY
KEARNY, AZ 85237

LINE #	QTY	DESCRIPTION	REMARKS	UNIT PRICE	TOTAL
1	1.00	LOCATABLE MINERALS / MINING CLAIMS-NOT NEW-UNADJUD, ONE AUTH NO. ONLY / MINING CLAIM MONEY RECEIVED (455) CASES: AMC361425/\$1750.00	MAINT 2006 - 14	- n/a -	1750.00
TOTAL:					\$1,750.00

PAYMENT INFORMATION			
1	AMOUNT:	\$1,750.00	POSTMARKED: N/A
	TYPE:	CHECK	RECEIVED: 08/12/2005
	CHECK NO:	1292	
	NAME:	SILVER KING MINING CO OF AZ 56389 E SIMMONS WAY KEARNY AZ 85237	

REMARKS

This receipt was generated by the automated BLM Collections and Billing System and is a paper representation of a portion of the official electronic record contained therein.

*\$250 Refunded 11/4/05 ARB
2 claims closed Amc 348184-348185*

United States Department of the Interior
Bureau of Land Management
 BUSINESS & SUPPORT SVCS DIV
 222 N CENTRAL AVE
 PHOENIX, AZ 85004 -2203
 Phone: (602) 417-9200

Receipt	
No:	695222

Transaction #: 723877
 Date of Transaction: 06/11/2003

ENTERED INTO COMPUTER
 6/24/03 TK

CUSTOMER: GARY DEEN
 56389 E SIMMONS WAY
 KEARNY, AZ 85237

LINE #	QTY	DESCRIPTION	REMARKS	UNIT PRICE	TOTAL
1	2.00	LOCATABLE MINERALS / MINING CLAIMS-NEW, UNADJUDI, ONE OR MORE AUTH NO'S / NEW MINING CLAIM LOCATION FEE \$25(1993) CASES: AMC358030/\$25.00, AMC358031/\$25.00		- n/a -	50.00
2	2.00	LOCATABLE MINERALS / MINING CLAIMS-NEW, UNADJUDI, ONE OR MORE AUTH NO'S / NEW MINING CLAIM SVC CHG \$10 (1930) CASES: AMC358030/\$10.00, AMC358031/\$10.00		- n/a -	20.00
3	2.00	LOCATABLE MINERALS / MINING CLAIMS-NEW, UNADJUDI, ONE OR MORE AUTH NO'S / NEW MINING CLM MAINT FEE \$100(1993) CASES: AMC358030/\$100.00, AMC358031/\$100.00	MAIN 2003 (2)	- n/a -	200.00
4	1.00	LOCATABLE MINERALS / MINING CLAIMS-NOT NEW-UNADJUD, ONE AUTH NO. ONLY / MINING CLAIM MONEY RECEIVED (455) CASES: AMC348183/\$600.00	MAIN 2004 (6)	- n/a -	600.00
5	1.00	SUSPENSE, MISCELLANEOUS / SUSPENSE, MISCELLANEOUS / TEMPORARY SUSPENSE, MISC (455)	NOI 2003 (2)	- n/a -	10.00
6	5.00	IAC PRODUCTS / COPIES / CASEFILE/DOCUMENT COPIES / COPIES (B/W UP TO 11X17)-\$.13/P		0.13	0.65

TOTAL: **\$880.65**

PAYMENT INFORMATION

1	AMOUNT	\$880.65	POSTMARKED	N/A
	TYPE	CHECK	RECEIVED	06/11/2003
	CHECK NO	1062		
	NAME	SILVER KING MINING CO 56389 E SIMMONS WAY KEARNY AZ 85237		

REMARKS

THE \$10. FEE IS FOR A NOI FOR AMC 358030 & AMC358031

This receipt was generated by the automated BLM Collections and Billing System and is a paper representation of a portion of the official electronic record contained therein.

NOTICE!!

These documents have been scanned!

Do not place un-scanned documents beneath this notice!

Do not remove this notice from this file!

GPO Jacket No. 560-102
Print Order 61540
Rise Business Services, LLC
Job=AZ15 6/6/2019



Box Number= AZ15122



Claim Begin-End: AMC358030-AMC358031

2 Correspondence



AZ15122-6

AMC357873-AMC358493

**NO
DOCUMENTS
FOUND**

NO DOCUMENTS FOUND
NO DOCUMENTS FOUND

NOTICE!!

These documents have been scanned!

Do not place un-scanned documents beneath this notice!

Do not remove this notice from this file!

GPO Jacket No. 560-102
Print Order 61540
Rise Business Services, LLC
Job=AZ15 6/6/2019



Box Number= AZ15122



Claim Begin-End: AMC358030-AMC358031

3 Transfers



AZ15122-6

AMC357873-AMC358493

**NO
DOCUMENTS
FOUND**

NO DOCUMENTS FOUND
NO DOCUMENTS FOUND

NOTICE!!

These documents have been scanned!

Do not place un-scanned documents beneath this notice!

Do not remove this notice from this file!

GPO Jacket No. 560-102
Print Order 61540
Rise Business Services, LLC
Job=AZ15 6/6/2019



Box Number= AZ15122



Claim Begin-End: AMC358030-AMC358031

4 Annual Filings



AZ15122-6 AMC357873-AMC358493

DEPARTMENT OF THE INTERIOR
BUREAU OF LAND MANAGEMENT
MINING CLAIMS

Run Date/Time: 8/16/2019

MC Maintenance Fees Paid Through the BLM Pay Portal
(by Date Paid)

Page 117 Of 122

CBS Receipt: 4531888

Printed For Lead File # AMC358030

Agency Tracking ID: 1565747160

Assessment Year: 2020

Number of BLM Serial Nr: 13

Paid On: 8/14/2019

Total Amount Paid: \$2,145.00

Claim Name	BLM Serial No	Lead File No	Amount Paid
EL MEDICO 2052	AMC348183	AMC348183	\$165.00
SILVER KING 1997 #1	AMC348186	AMC348183	\$165.00
SILVER KING 1997 #2	AMC348187	AMC348183	\$165.00
SILVER KING 1997 #3	AMC348188	AMC348183	\$165.00
SILVER KING SOUTH	AMC348984	AMC348984	\$165.00
SILVER KING S W	AMC348985	AMC348984	\$165.00
SILVER KING 1997	AMC358030	AMC358030	\$165.00
SILVER KING 1997 #4	AMC358031	AMC358030	\$165.00
JUAN	AMC372553	AMC372553	\$165.00
RIPSEY HILL NO. 2	AMC372554	AMC372553	\$165.00
RIPSEY HILL NO. 7	AMC372555	AMC372553	\$165.00
BLACK EAGLE 2006	AMC404144	AMC404144	\$165.00
SILVERKING MINE 2017	AMC448728	AMC448728	\$165.00

United States Department of the Interior
Bureau of Land Management
 BUSINESS & SUPPORT SVCS DIV
 ONE N CENTRAL AVE SUITE 800
 PHOENIX, AZ 85004 -4427
 Phone: 602-417-9200

Receipt	
No:	4531888

Transaction #: 4652752	
Date of Transaction: 08/13/2019	
CUSTOMER:	
RONALD DEEN 56389 E. SIMMONS WAY KEARNY, AZ 85137 US	

LINE #	QTY	DESCRIPTION	REMARKS	UNIT PRICE	TOTAL
1	1.00	LOCATABLE MINERALS / MINING CLAIMS- NOT NEW-UNADJUD, ONE AUTH NO. ONLY / MINING CLAIM MONEY RECEIVED CASES: AMC348183/\$2145.00		- n/a -	2145.00
TOTAL:					\$2,145.00

PAYMENT INFORMATION			
NOTE: Items will appear on credit card statement as "BLM O Mining Claim".			
1	AMOUNT:	2145.00	POSTMARKED: N/A
	TYPE:	CREDIT CARD	RECEIVED: 08/13/2019
	NAME:	RONALD DEEN 56389 E. SIMMONS WAY KEARNY AZ 85137 US	
	CARD NO:	XXXXXXXXXXXX6479	AUTH CODE: 01348P
	NAME ON CARD:	RONALD DEEN	
	SIGNATURE:	INTERNET	

REMARKS

This receipt was generated by the automated BLM Collections and Billing System and is a paper representation of a portion of the official electronic record contained therein.

348183

448727

372553

348984

360019

361425

~~358030~~

376993

361425

448728

404144

MAINTENANCE FEE PAYMENT

Claimant Name: DEEN / SILVER KING MINE

Address: 56389 East Simmons Way

City: Kearny State: Az Zip: 85137

Telephone: 520-363-5692

E-mail address: _____

Signature: Kay Deen

Check here if this is a change of address.

RECEIVED
 PLM AZ STATE OFFICE
 PHOENIX, ARIZONA
 2018 AUG 24 P 12: 16
 BLM
 Date
 Stamp

LINE NO.	AMC NUMBER	CLAIM/SITE NAME	COUNTY RECORDER DATA (If available)	TWP	RNG	SEC
1	348183	EL MEDICO 2052	Fee No. 1997-035009	1S	12E	24
2	348186	SILVER KING 1997 #1	Fee No. 1997-035010	1S	12E	24
3	348187	SILVER KING 1997 #2	Fee No. 1997-035011	1S	12E	24
4	348188	SILVER KING 1997 #3	Fee No. 1997-035012	1S	12E	24
5	348984	SILVER KING SOUTH	Fee No. 1997-043840	1S	12E	24
6	348985	SILVER KING SW	Fee No. 1997-043839	1S	12E	24
7	358030	SILVER KING 1997	Fee No. 2003-040453	1S	12E	24
8	358031	SILVER KING 1997 #4	Fee No. 2003-040452	1S	12E	24
9	361426	SILVER KING 1997 #8	Fee No. 2004-024495	1S	12E	24
10	361427	SILVER KING 1997 #9	Fee No. 2004-024496	1S	12E	24

List additional claims on Form MCF114.

Bureau of Land Management
Arizona State Office
www.blm.gov/az/

No. of Claims: _____ x \$140 = _____
 Check No: _____ Init. _____
 Receipt No.: 4243711
 For BLM Use Only

Form: MCF112
Revised July 2009

This form is available from the Arizona Department of Mines and Mineral Resources and may be reproduced.

ENTERED
AUG 28 2018
BY: lm

1021

MAINTENANCE FEE PAYMENT

Claimant Name: DEEN / Tunnel Mine
 Address: 56389 East Simmons Way
 City: Kearny State: Az zip: 85137
 Telephone: 520-363 5692
 E-mail address: _____
 Signature: Ronald Deen

Check here if this is a change of address.

RECEIVED
 BLM AZ STATE OFFICE
 2010 AUG 24 P 12: 16
 PHOENIX, ARIZONA
 BLM
 Date
 Stamp

LINE NO.	AMC NUMBER	CLAIM/SITE NAME	COUNTY RECORDER DATA (If available)	TWP	RNG	SEC
1	404144	Black Eagle 2006	2011-004936	1S	12E	14
2						
3						
4						
5						
6						
7						
8						
9						
10						

List additional claims on Form MCF114.

Bureau of Land Management
 Arizona State Office
 www.blm.gov/az/

No. of Claims: _____ x \$140 = _____
 Check No: _____ Init: 155
 Receipt No.: _____
For BLM Use Only



Mr. Ronald Deen
56389 E Simmons Way
Kearny, AZ 85137-6017

MAINTENANCE FEE PAYMENT

Claimant Name: DEEN / THE H.H.H. MINE
 Address: 56389 East Simmons Way
 City: Kearny State: AZ Zip: 85137
 Telephone: 520-363-5692
 E-mail address: _____
 Signature: Ronald Deen

Check here if this is a change of address.

RECEIVED
 BLM AZ STATE OFFICE
 2010 AUG 24 P 12:16
 PHOENIX, ARIZONA
 BLM
 Date
 Stamp

LINE NO.	AMC NUMBER	CLAIM/SITE NAME	COUNTY RECORDER DATA (If available)	TWP	RNG	SEC
1	372553	JUAN (1982)	Fee No. 2006-090456	3S	13E	7
2	361428	GALENA No. 1 1992	Fee No. 2004-024488	3S	13E	7SW 1/4
3						
4						
5						
6						
7						
8						
9						
10						

List additional claims on Form MCF114.

Bureau of Land Management
 Arizona State Office
www.blm.gov/az/

No. of Claims: 2 x \$140 = \$310
 Check No: _____ Init: _____
 Receipt No.: _____
For BLM Use Only

Form: MCF112
 Revised July 2009

This form is available from the Arizona Department of Mines and Mineral Resources and may be reproduced.

Ronald Deen
56389 E. Simmons Way
Kearny, AZ 85137

MAINTENANCE FEE PAYMENT ^①/FLORENCE MINE

Claimant Name: DEEN ^②/THE VIEJO RELEGAD MINE

Address: 56389 East Simmons Way ^③/RIPSEY MINE

City: Kearny State: AZ Zip: 85137

Telephone: 520-363-5692

E-mail address: _____

Signature: *Ronald Deen*

Check here if this is a change of address.

RECEIVED
BLM AZ STATE OFFICE
PHOENIX, ARIZONA
2018 AUG 24 P 12: 16
BLM
Date
Stamp

LINE NO.	AMC NUMBER	CLAIM/SITE NAME	COUNTY RECORDER DATA (If available)	TWP	RNG	SEC
1	361424	RIPSEY HILL No.1 1994	04/06/04	5S	13E	12/
2	372554	RIPSEY HILL No.2 1997	06/26/06	5S	13E	12
3	376995	RIPSEY HILL No.3 1997	01/12/07	5S	13E	12
4	376996	RIPSEY HILL No.4 1997	01/12/07	5S	13E	12
5	372555	RIPSEY HILL No.7 1997	06/26/06	5S	13E	12/
6						
7						
8						
9						
10						

361424
CLOSED
361425

List additional claims on Form MCF114.

Bureau of Land Management
Arizona State Office
www.blm.gov/az/

No. of Claims: _____ x \$140 = _____
 Check No: _____ Init: _____
 Receipt No.: _____
 For BLM Use Only

Form: MCF117
Revised July 2009

This form is available from the Arizona Department of Mines and Mineral Resources and may be reproduced.

D

Mr. Ronald Deen
56389 E Simmons Way
Kearny, AZ 85137

MAINTENANCE FEE PAYMENT

THE SILVER KING

Claimant Name: Ron Deen/Gary Deen/ MINING Co.

Address: 56389 East Simmons Way

City: Kearny State: AZ Zip: 85137

Telephone: 520-363-5692/cell 520-840-0753

E-mail address: _____

Signature: Ron Deen

Check here if this is a change of address.

RECEIVED
BLM AZ STATE OFFICE
2018 AUG 24 P 12: 16
PHOENIX, ARIZONA

BLM
Date
Stamp

LINE NO.	AMC NUMBER	CLAIM/SITE NAME	COUNTY RECORDER DATA (If available)	TWP	RNG	SEC
1	448728	THE SILVER KING MINE 2017	02/05/2018 955 Page 1 Fee No. 2018-008438	15	12E	24
2						
3						
4						
5						
6						
7						
8						
9						
10						

List additional claims on Form MCF114.

Bureau of Land Management
Arizona State Office
www.blm.gov/az/

No. of Claims*: _____ x \$155 = _____
 Check No: _____ Init. _____
 Receipt No.: _____
 For BLM Use Only

* \$155 per lode mining claim, mill site, or tunnel site; and \$155 for each 20 acres or portion thereof for each placer mining claim.

Form: MCF112
Revised July 2014

This form is available from the Arizona Geological Survey and may be reproduced.

505

D

Mr. Ronald Deen
56389 E Simmons Way
Kearny, AZ 85137

MAINTENANCE FEE PAYMENT

Claimant Name: Ron Deen/Gary Deen
Address: 56389 East Simmons Way
City: Kearny State: AZ Zip: 85137
Telephone: 520-363-5692, Rosa Lea Mine
E-mail address: cell 520-846-0753
Signature: Ron Deen

Check here if this is a change of address.

RECEIVED
BLM AZ STATE OFFICE
2018 AUG 24 P 12:16
PHOENIX, ARIZONA
BLM
Date
Stamp

LINE NO.	AMC NUMBER	CLAIM/SITE NAME	COUNTY RECORDER DATA (if available)	TWP	RNG	SEC
1	448727	THE ROSA LEA MINE 1911 2018	Fee Number 2018-008439	4S	14E	18
2						
3						
4						
5						
6						
7						
8						
9						
10						

List additional claims on Form MCF114.

Bureau of Land Management
Arizona State Office
www.blm.gov/az/

No. of Claims*: _____ x \$155 = _____
 Check No: _____ Init. _____
 Receipt No.: _____
 For BLM Use Only

* \$155 per lode mining claim, mill site, or tunnel site; and \$155 for each 20 acres or portion thereof for each placer mining claim.

Form: MCF112
Revised July 2014

This form is available from the Arizona Geological Survey and may be reproduced.

3096

UNITED STATES
DEPARTMENT OF THE INTERIOR
BUREAU OF LAND MANAGEMENT
**MAINTENANCE FEE PAYMENT FORM FOR
LODE CLAIMS, MILL SITES, AND TUNNEL SITES**

Remitter Name: JACK Sanfelice
 Mailing Address: 6237 E. MALLORY
 City, State, Zip: NOEN AZ 85215

Check here if this is a change of address.

FOR COUNTY RECORDER'S USE

No. of claims/sites 1
 x \$155 per claim/site
 Total due BLM \$⁰ 155.00

- The maintenance fee may be paid by cash, check, money order, Bureau of Land Management (BLM) Declining Deposit Account, or credit card (VISA, American Express, Discover, or MasterCard). Payments must be remitted to the BLM State Office where your claim or site is recorded and received on or before September 1. If the payment is mailed, the envelope must be postmarked by a bona fide delivery service on or before September 1 and received at the proper BLM State Office within 15 calendar days after the due date. Payments may also be made by telephone using a credit card. A complete listing of BLM State Offices with their addresses and phone numbers can be found at <http://www.blm.gov>.
- The maintenance fee for the following claim(s)/site(s) applies to the assessment year _____.

CLAIM/SITE NAME	BLM SERIAL NO.
<u>Pinto Creek mystery mine</u>	<u>360019</u>

RECEIVED
 BLM STATE OFFICE
 PHOENIX, ARIZONA
 2010 AUG 24 P 12:17

Use a separate sheet for additional claim/site names, serial numbers, and claimant names and addresses.

United States Department of the Interior
Bureau of Land Management
 DIV OF LANDS, MINRLS & ENERGY
 ONE N CENTRAL AVE
 PHOENIX, AZ 85004 -4427
 Phone: 602-417-9200

Receipt

No: 4243711

Transaction #: 4359151	
Date of Transaction: 08/24/2018	
CUSTOMER:	
RONALD R DEEN 56389 E SIMMONS WAY KEARNY, AZ 85137-6017 US	

LINE #	QTY	DESCRIPTION	REMARKS	UNIT PRICE	TOTAL
1	1.00	LOCATABLE MINERALS / MINING CLAIMS- NOT NEW-UNADJUD, ONE AUTH NO. ONLY / MINING CLAIM MONEY RECEIVED CASES: AMC348183/\$3255.00	MAINT 2019/21	- n/a -	3255.00
TOTAL:					\$3,255.00

PAYMENT INFORMATION			
NOTE: Items will appear on credit card statement as "Bureau of Land Mgmt CO".			
1	AMOUNT:	3255.00	POSTMARKED: N/A
	TYPE:	CREDIT CARD	RECEIVED: 08/24/2018
	NAME:	DEEN, RONALD R 56389 E SIMMONS WAY KEARNY AZ 85137-6017 US	
	CARD NO:	XXXXXXXXXXXX9852	AUTH CODE: 66530D
	NAME ON CARD:	RONALD DEEN	
	SIGNATURE:		

REMARKS

This receipt was generated by the automated BLM Collections and Billing System and is a paper representation of a portion of the official electronic record contained therein.

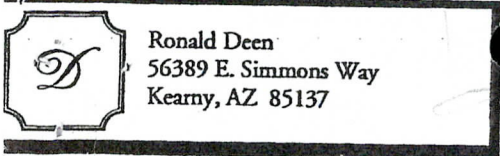

Ronald Deen
56389 E. Simmons Way
Kearny, AZ 85137

361425
348984
358030
372553
376993
404144
348183

MAINTENANCE FEE PAYMENT ①/FLORENCE MINE

Claimant Name: DEEN ②/THE VIEJO RELEGAD MINE
 Address: 56389 East Simmons Way ③/RIPSEY MINE
 City: Kearny State: Az Zip: 85137
 Telephone: 520-363-5692
 E-mail address: _____
 Signature: Ronald Deen

RECEIVED
ARIZONA STATE OFFICE
PHOENIX, ARIZONA
2011 AUG 14 P 12:02
BLM Date Stamp

Check here if this is a change of address.

LINE NO.	AMC NUMBER	CLAIM/SITE NAME	COUNTY RECORDER DATA (If available)	TWP	RNG	SEC
1	361424	RIPSEY HILL No. 1 1994	04/06/04	5S	13E	12/
2	372554	RIPSEY HILL No. 2 1997	06/26/06	5S	13E	12
3	376995	RIPSEY HILL No. 3 1997	01/12/07	5S	13E	12
4	376996	RIPSEY HILL No. 4 1997	01/12/07	5S	13E	12
5	372555	RIPSEY HILL No. 7 1997	06/26/06	5S	13E	12/
6						
7						
8						
9						
10						

List additional claims on Form MCF114.

Bureau of Land Management
Arizona State Office
www.blm.gov/az

No. of Claims: 18 x \$140 = 2,520
 Check No: CC Init. 4/11/11
 Receipt No.: 3935567
 For BLM Use Only

Form: MCF117
Revised July 2009

This form is available from the Arizona Department of Mines and Mineral Resources and may be reproduced.

ENTERED
AUG 15 2017
BY: Ram

Mr. Ronald Deen
 56389 E Simmons Way
 Kearny, AZ 85137-6017

MAINTENANCE FEE PAYMENT

Claimant Name: DEEN / Tunnel Mine
 Address: 56389 East Simmons Way
 City: Kearny State: AZ zip: 85137
 Telephone: 520-363 5692
 E-mail address: _____
 Signature: Ronald Deen
 Check here if this is a change of address.

RECEIVED
 CLM AZ STATE OFFICE
 2017 AUG 14 P 12: 02
 PHOENIX, ARIZONA
 BLM
 Date
 Stamp

LINE NO.	AMC NUMBER	CLAIM/SITE NAME	COUNTY RECORDER DATA (If available)	TWP	RNG	SEC
1	404144	Black Eagle 2006	2011-004936	1S	12E	14
2						
3						
4						
5						
6						
7						
8						
9						
10						

List additional claims on Form MCF114.

Bureau of Land Management
 Arizona State Office
 www.blm.gov/az

No. of Claims: _____ x \$140 = _____
 Check No: _____ Init: 155
 Receipt No.: _____
 For BLM Use Only

Form: MCF117
 Revised July 2009

This form is available from the Arizona Department of Mines and Mineral Resources and may be reproduced.



Mr. Ronald Deen
 56389 E Simmons Way
 Kearny, AZ 85137-6017

MAINTENANCE FEE PAYMENT

Claimant Name: DEEN / THE H.H.H MINE
 Address: 56389 East Simmons Way
 City: Kearny State: AZ Zip: 85137
 Telephone: 520-363-5692
 E-mail address: _____
 Signature: Ronald Deen

Check here if this is a change of address.

RECEIVED
 ARIZONA STATE OFFICE
 PHOENIX, ARIZONA
 2011 AUG 14 P 12:02
 BLM
 Date
 Stamp

LINE NO.	AMC NUMBER	CLAIM/SITE NAME	COUNTY RECORDER DATA (If available)	TWP	RNG	SEC
1	372553	JUAN (1982)	Fee No. 2006-090456	3S	13E	7
2	361428	GALENA No. 1 1992	Fee No. 2004-024488	3S	13E	7SW/4
3						
4						
5						
6						
7						
8						
9						
10						

List additional claims on Form MCF114.

Bureau of Land Management
 Arizona State Office
www.blm.gov/az/

No. of Claims: 2 x \$140 = \$310
 Check No: _____ Init: _____
 Receipt No.: _____
 For BLM Use Only

Form: MCF112
 Revised July 2009

This form is available from the Arizona Department of Mines and Mineral Resources and may be reproduced.



Mr. Ronald Deen
 56389 E Simmons Way
 Kearny, AZ 85137-6017

MAINTENANCE FEE PAYMENT

Claimant Name: DEEN/SILVER KING MINE
 Address: 56389 East Simmons Way
 City: Kearny State: AZ zip: 85137
 Telephone: 520-363-5692
 E-mail address: _____
 Signature: [Handwritten Signature]

Check here if this is a change of address.

RECEIVED
 BLM AZ STATE OFFICE
 PHOENIX, ARIZONA
 2011 AUG 14 P 12:02
 BLM
 Date
 Stamp

LINE NO.	AMC NUMBER	CLAIM/SITE NAME	COUNTY RECORDER DATA (if available)	TWP	RNG	SEC
1	348183	EL MEDICO 2052	Fee No. 1997-035009	1S	12E	24
2	348186	SILVER KING 1997#1	Fee No. 1997-035010	1S	12E	24
3	348187	SILVER KING 1997#2	Fee No. 1997-035011	1S	12E	24
4	348188	SILVER KING 1997#3	Fee No. 1997-035012	1S	12E	24
5	348984	SILVER KING SOUTH	Fee No. 1997-043840	1S	12E	24
6	348985	SILVER KING SW	Fee No. 1997-043839	1S	12E	24
7	358030	SILVER KING 1997	Fee No. 2003-040453	1S	12E	24
8	358031	SILVER KING 1997#4	Fee No. 2003-040452	1S	12E	24
9	361426	SILVER KING 1997#8	Fee No. 2004-024495	1S	12E	24
10	361427	SILVER KING 1997#9	Fee No. 2004-024496	1S	12E	24

List additional claims on Form MCF114.

Bureau of Land Management
 Arizona State Office
 www.blm.gov/az

No. of Claims: _____ x \$140 = _____
 Check No: _____ Init. _____
 Receipt No.: _____
For BLM Use Only

Form: MCF112
 Revised July 2009

United States Department of the Interior
Bureau of Land Management
 DIV OF LANDS, MINRLS & ENERGY
 ONE N CENTRAL AVE
 PHOENIX, AZ 85004 -4427
 Phone: 602-417-9200

Receipt

No: 3935567

Transaction #: 4045173	
Date of Transaction: 08/14/2017	
CUSTOMER:	
RONALD R DEEN 56389 E SIMMONS WAY KEARNY, AZ 85137-6017 US	

LINE #	QTY	DESCRIPTION	REMARKS	UNIT PRICE	TOTAL
1	1.00	LOCATABLE MINERALS / MINING CLAIMS- NOT NEW-UNADJUD, ONE AUTH NO. ONLY / MINING CLAIM MONEY RECEIVED CASES: AMC372554/\$2790.00	MAINT 2018/18	- n/a -	2790.00
TOTAL:					\$2,790.00

PAYMENT INFORMATION			
NOTE: Items will appear on credit card statement as "Bureau of Land Mgmt CO".			
1	AMOUNT:	2790.00	POSTMARKED: N/A
	TYPE:	CREDIT CARD	RECEIVED: 08/14/2017
	NAME:	DEEN, RONALD R 56389 E SIMMONS WAY KEARNY AZ 85137-6017 US	
	CARD NO:	XXXXXXXXXXXX6479	AUTH CODE: 01442B
	NAME ON CARD:	RONALD DEEN	
	EXPIRES:	09/2018	
	SIGNATURE:		

REMARKS

This receipt was generated by the automated BLM Collections and Billing System and is a paper representation of a portion of the official electronic record contained therein.



Mr. Ronald Deen
56389 E Simmons Way
Kearny, AZ 85137-6017

~~348183~~
404144

348183
348984
358030
361425
361420
372553
376993

MAINTENANCE FEE PAYMENT

Claimant Name: DEEN/SILVER KING MINE
Address: 56389 East Simmons Way
City: Kearny State: Az Zip: 85137
Telephone: 520-363-5692
E-mail address: _____
Signature: [Signature]

RECEIVED
BLM AZ STATE OFFICE
2016 AUG 12 A 11: 06
PHOENIX, ARIZONA
BLM
Date
Stamp

Check here if this is a change of address.

LINE NO.	AMC NUMBER	CLAIM/SITE NAME	COUNTY RECORDER DATA (If available)	TWP	RNG	SEC
1	348183	EL MEDICO 2052	Fee No. 1997-035009	1S	12E	24
2	348186	SILVER KING 1997#1	Fee No. 1997-035010	1S	12E	24
3	348187	SILVER KING 1997#2	Fee No. 1997-035011	1S	12E	24
4	348188	SILVER KING 1997#3	Fee No. 1997-035012	1S	12E	24
5	348984	SILVER KING SOUTH	Fee No. 1997-043840	1S	12E	24
6	348985	SILVER KING SW	Fee No. 1997-043839	1S	12E	24
7	358030	SILVER KING 1997	Fee No. 2003-040453	1S	12E	24
8	358031	SILVER KING 1997#4	Fee No. 2003-040452	1S	12E	24
9	361426	SILVER KING 1997#8	Fee No. 2004-024495	1S	12E	24
10	361427	SILVER KING 1997#9	Fee No. 2004-024496	1S	12E	24

List additional claims on Form MCF114.

Bureau of Land Management
Arizona State Office
www.blm.gov/az

No. of Claims: 10 x \$140 = 1550
Check No: 2265 Init. [Signature]
Receipt No.: 3628838
For BLM Use Only

Form: MCF117
Revised July 2009

This form is available from the Arizona Department of Mines and Mineral Resources and may be reproduced.

AUG 15 2016
BY: RAM

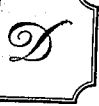

Ronald Deen
56389 E. Simmons Way
Kearny, AZ 85137

MAINTENANCE FEE PAYMENT ^①/FLORENCE MINE

Claimant Name: DEEN ^②/THE VEJO RELEGAD MINE
 Address: 56389 East Simmons Way ^③/RIPSEY MINE
 City: Kearny State: AZ Zip: 85137
 Telephone: 520-363-5692
 E-mail address: _____
 Signature: Ronald Deen

Check here if this is a change of address.

RECEIVED
 BLM AZ STATE OFFICE
 PHOENIX, ARIZONA
 2016 AUG 12 A 11: 09
 BLM
 Date
 Stamp

LINE NO.	AMC NUMBER	CLAIM/SITE NAME	COUNTY RECORDER DATA (If available)	TWP	RNG	SEC
1	361424 ⁵	RIPSEY HILL No.1 1994	04/06/04	5S	13E	12/
2	372554	RIPSEY HILL No.2 1997	06/26/06	5S	13E	12
3	376995	RIPSEY HILL No.3 1997	01/12/07	5S	13E	12
4	376996	RIPSEY HILL No.4 1997	01/12/07	5S	13E	12
5	372555	RIPSEY HILL No.7 1997	06/26/06	5S	13E	12/
6						
7						
8						
9						
10						

List additional claims on Form MCF114.

Bureau of Land Management
Arizona State Office
www.blm.gov/az/

No. of Claims: 5 *~~5140~~ = 775
 Check No: 2265 Init. EDG
 Receipt No.: 3628838
 For BLM Use Only

Form: MCF117
Revised July 2009



Mr. Ronald Deen
 56389 E Simmons Way
 Kearny, AZ 85137-6017

MAINTENANCE FEE PAYMENT

Claimant Name: DEEN / THE H.H.H. MINE
 Address: 56389 East Simmons Way
 City: Kearny State: AZ Zip: 85137
 Telephone: 520-363-5692
 E-mail address: _____
 Signature: Ronald Deen

Check here if this is a change of address.

RECEIVED
 BLM AZ STATE OFFICE
 2016 AUG 12 A 11:06
 PHOENIX, ARIZONA
 BLM
 Date
 Stamp

LINE NO.	AMC NUMBER	CLAIM/SITE NAME	COUNTY RECORDER DATA (If available)	TWP	RNG	SEC
1	372553	JUAN (1982)	Fee No. 2006-090456	3S	13E	7
2	361428	GALENA No. 1 1992	Fee No. 2004-024488	3S	13E	7SW/4
3						
4						
5						
6						
7						
8						
9						
10						

List additional claims on Form MCF114.

Bureau of Land Management
 Arizona State Office
www.blm.gov/az/

No. of Claims: 2 x \$~~140~~ = 310
 Check No: 2265 Init. ED
 Receipt No.: 3628838
For BLM Use Only

Form: MCF114
 Revised July 2009

 **Mr. Ronald Deen**
 56389 E Simmons Way
 Kearny, AZ 85137-6017

MAINTENANCE FEE PAYMENT

Claimant Name: DEEN / Tunnel Mine
 Address: 56389 East Simmons Way
 City: Kearny State: AZ Zip: 85137
 Telephone: 520-363 5692
 E-mail address: _____
 Signature: Ronald Deen

Check here if this is a change of address.

RECEIVED
 BLM AZ STATE OFFICE
 2016 AUG 12 A 11:06
 PHOENIX, ARIZONA
 BLM Date Stamp

LINE NO.	AMC NUMBER	CLAIM/SITE NAME	COUNTY RECORDER DATA (If available)	TWP	RNG	SEC
1	404144	Black Eagle 2006	2011-004936	1S	12E	14
2						
3						
4						
5						
6						
7						
8						
9						
10						

List additional claims on Form MCF114.

Bureau of Land Management
 Arizona State Office
 www.blm.gov/az

No. of Claims: 1 x \$140 = 140
 Check No: 2265 Init: EDG
 Receipt No.: 3628838
 For BLM Use Only

Form: MCF114
 Revised July 2009

This form is available from the Arizona Department of Mines and Mineral Resources and may be reproduced.

**United States Department of the Interior
Bureau of Land Management
DIV OF LANDS, MINRLS & ENERGY
ONE N CENTRAL AVE
PHOENIX, AZ 85004 -4427
Phone: 602-417-9200**

Receipt

No: 3628838

Transaction #: 3732609	
Date of Transaction: 08/12/2016	
CUSTOMER:	
RONALD R DEEN 56389 E SIMMONS WAY KEARNY, AZ 85237-6017 US	

LINE #	QTY	DESCRIPTION	REMARKS	UNIT PRICE	TOTAL
1	1.00	LOCATABLE MINERALS / MINING CLAIMS- NOT NEW-UNADJUD, ONE AUTH NO. ONLY / MINING CLAIM MONEY RECEIVED CASES: AMC348183/\$2790.00	2017 MAINT (18)	- n/a -	2790.00
TOTAL:					\$2,790.00

PAYMENT INFORMATION					
1	AMOUNT:	2790.00	POSTMARKED:	N/A	
	TYPE:	CHECK	RECEIVED:	08/12/2016	
	CHECK NO:	2265			
	NAME:	SILVER KING MINING CO DEEN, RON 56389 E SIMMONS WAY KEARNY AZ 85237-6017 US			

REMARKS

This receipt was generated by the automated BLM Collections and Billing System and is a paper representation of a portion of the official electronic record contained therein.



BLM - PHOENIX OFFICE
 56389 E Simmons Way
 Kearny, AZ 85137-6017

348183
 984 348984
 358030
 361425
 404144
 372553
 376993
 360019

ASSESSMENT YEAR

MAINTENANCE FEE PAYMENT SILVER KING MINING CO.

Claimant Name: DEEN / SILVER KING MINE

Address: 56389 East Simmons Way

City: Kearny State: AZ Zip: 85137

Telephone: 520-363-5692

E-mail address:

Signature: *Kon Deen*

Check here if this is a change of address.

RECEIVED
 ARIZONA STATE OFFICE
 PHOENIX, ARIZONA
 2015 AUG 24 A 11: 21
 BLM
 Date
 Stamp

LINE NO.	AMC NUMBER	CLAIM/SITE NAME	COUNTY RECORDER DATA (If available)	TWP	RNG	SEC
1	348183	EL MEDICO 2052	Fee No. 1997-035009	1S	12E	24
2	348186	SILVER KING 1997 #1	Fee No. 1997-035010	1S	12E	24
3	348187	SILVER KING 1997 #2	Fee No. 1997-035011	1S	12E	24
4	348188	SILVER KING 1997 #3	Fee No. 1997-035012	1S	12E	24
5	348984	SILVER KING SOUTH	Fee No. 1997-043840	1S	12E	24
6	348985	SILVER KING SW	Fee No. 1997-043839	1S	12E	24
7	358030	SILVER KING 1997	Fee No. 2003-040453	1S	12E	24
8	358031	SILVER KING 1997 #4	Fee No. 2003-040452	1S	12E	24
9	361426	SILVER KING 1997 #8	Fee No. 2004-024495	1S	12E	24
10	361427	SILVER KING 1997 #9	Fee No. 2004-024496	1S	12E	24

List additional claims on Form MCF114.

Bureau of Land Management
 Arizona State Office
 www.blm.gov/az1

No. of Claims: 19 x \$140 = 2945.⁰⁰
 Check No: 2145 Init. PER
 Receipt No.: 3374688
 For BLM Use Only

Form: MCF112
 Revised July 2009

This form is available from the Arizona Department of Mines and Mineral Resources and may be reproduced.

NOTIFIED OF INCORRECT AMC # BY MAIL.
 10/27/15 JR

ENTERED
 AUG 25 2015
 BY: IR



Mr. Ronald Deen
56389 E Simmons Way
Kearny, AZ 85137-6017

20 ASSESSMENT YEAR
MAINTENANCE FEE PAYMENT SILVER KING MINING CO.

Claimant Name: DEEN / Tunnel Mine
Address: 56389 East Simmons Way
City: Kearny State: Az Zip: 85137
Telephone: 520-363 5692
E-mail address: _____
Signature: Ronald Deen

RECEIVED
BLM AZ STATE OFFICE
2015 AUG 24 A 11: 27
PHOENIX, ARIZONA
BLM
Date
Stamp

Check here if this is a change of address.

LINE NO.	AMC NUMBER	CLAIM/SITE NAME	COUNTY RECORDER DATA (If available)	TWP	RNG	SEC
1	404144	Black Eagle 2006	2011-004936	1S	12E	14
2						
3						
4						
5						
6						
7						
8						
9						
10						

List additional claims on Form MCF114.

Bureau of Land Management
Arizona State Office
www.blm.gov/az/

No. of Claims: 1 x \$140 = 155
Check No: _____ Init: 155
Receipt No.: _____
For BLM Use Only

Form: MCF117
Revised July 2009

This form is available from the Arizona Department of Mines and Mineral Resources and may be reproduced.



Ronald Deen
56389 E. Simmons Way
Kearny, AZ 85137

ASSESSMENT YEAR

MAINTENANCE FEE PAYMENT ^①/FLORENCE MINE

Claimant Name: DEEN ^②/THE VIEJO RELEGAD MINE

Address: 56389 East Simmons Way
③/RIPSEY MINE

City: Kearny State: Az Zip: 85137

Telephone: 520-363-5692

E-mail address: _____

Signature: Ronald Deen

Check here if this is a change of address.

RECEIVED
 AZ STATE OFFICE
 PHOENIX, ARIZONA
 2005 AUG 24 A 11:27
 BLM Date Stamp

*closed
wrong
Amc #
used*

LINE NO.	AMC NUMBER	CLAIM/SITE NAME	COUNTY RECORDER DATA (if available)	TWP	RNG	SEC
1	361424 ^S	RIPSEY HILL No.1 1994	04/06/04	5S	13E	12/
2	372554	RIPSEY HILL No.2 1997	06/26/06	5S	13E	12
3	376995	RIPSEY HILL No.3 1997	01/12/07	5S	13E	12
4	376996	RIPSEY HILL No.4 1997	01/12/07	5S	13E	12
5	372555	RIPSEY HILL No.7 1997	06/26/06	5S	13E	12/
6						
7						
8						
9						
10						

List additional claims on Form MCF114.

Bureau of Land Management
Arizona State Office
www.blm.gov/az/

No. of Claims: _____ x \$140 = _____
 Check No: _____ Init. 155
 Receipt No.: _____
 For BLM Use Only

Form: MCF117
Revised July 2009

This form is available from the Arizona Department of Mines and Mineral Resources and may be reproduced.

ASSESSMENT YEAR

MAINTENANCE FEE PAYMENT

Claimant Name: DEEN / THE H. H. H. MINE
 Address: 56389 East Simmons Way
 City: Kearny State: AZ Zip: 85137
 Telephone: 520-363-5692
 E-mail address: _____
 Signature: Ronald Deen

Check here if this is a change of address.

RECEIVED
 U.S. ARMY STATE OFFICE
 PHOENIX, ARIZONA
 2015 AUG 24 A 11: 27
 BLM
 Date
 Stamp

LINE NO.	AMC NUMBER	CLAIM/SITE NAME	COUNTY RECORDER DATA (If available)	TWP	RNG	SEC
1	372553	Tuoh (1982)	FEE No: 2006-090456	3S	13E	7
2	361428	Galena No. 1 1992	FEE No: 2004-024488	3S	13E	7SW/4
3						
4						
5						
6						
7						
8						
9						
10						

List additional claims on Form MCF114.

Bureau of Land Management
Arizona State Office
www.az.blm.gov

No. of Claims: 2 x \$125 = 280
 Check No: _____ Init. 155
 Receipt No.: _____
 For BLM Use Only

Form: MCF112
Revised July 2005

This form is available from the Arizona Department of Mines and Mineral Resources and may be reproduced.

04/01/09
07/28/09

MAINTENANCE FEE PAYMENT

Claimant Name: JACK SANTFELICE
 Address: 6237 E. MALLORY ST
 City: MESA State: AZ Zip: 85215
 Telephone: 602-5267688
 E-mail address: AZJACK212@GMAIL.COM
 Signature: Jack SantFelic

RECEIVED
 U.S. BUREAU OF LAND MANAGEMENT
 ARIZONA STATE OFFICE
 PHOENIX, ARIZONA
 2015 AUG 24 A 11:28
 BLM
 Date
 Stamp

Check here if this is a change of address.

LINE NO.	AMC NUMBER	CLAIM/SITE NAME	COUNTY RECORDER DATA (if available)	TWP	RNG	SEC
1	360019	PINTO CREEK MYSTERY MINE		1S	14E	8
2						
3						
4						
5						
6						
7						
8						
9						
10						

List additional claims on Form MCF114.

Bureau of Land Management
Arizona State Office
www.blm.gov/az/

No. of Claims*: 1 x \$155 = _____
 Check No: _____ Init. _____
 Receipt No.: 3374688
For BLM Use Only

* \$155 per lode mining claim, mill site, or tunnel site; and \$155 for each 20 acres or portion thereof for each placer mining claim.

Form: MCF112
 Revised July 2014

United States Department of the Interior
Bureau of Land Management
 LANDS/RECREATION & PLANNING
 ONE N CENTRAL AVE
 PHOENIX, AZ 85004 -2203
 Phone: 602-417-9200

Receipt

No: 3374688

Transaction #: 3472890	
Date of Transaction: 08/24/2015	
CUSTOMER:	
SILVER KING MINING COMPANY OF ARIZONA LLC 56389 E SIMMONS WAY KEARNY, AZ 85137-6017 US	

LINE #	QTY	DESCRIPTION	REMARKS	UNIT PRICE	TOTAL
1	1.00	LOCATABLE MINERALS / MINING CLAIMS-NOT NEW-UNADJUD, ONE AUTH NO. ONLY / MINING CLAIM MONEY RECEIVED CASES: AMC348183/\$2945.00	2016 MAINT/19	- n/a -	2945.00
TOTAL:					\$2,945.00

PAYMENT INFORMATION					
1	AMOUNT:	2945.00	POSTMARKED:	N/A	
	TYPE:	CHECK	RECEIVED:	08/24/2015	
	CHECK NO:	2145			
	NAME:	SILVER KING MINING COMPANY OF ARIZONA LLC 56389 E SIMMONS WAY KEARNY AZ 85137-6017 US			

REMARKS

This receipt was generated by the automated BLM Collections and Billing System and is a paper representation of a portion of the official electronic record contained therein.

ENTERED
 AUG 25 2015
 BY: IR

UNITED STATES DEPARTMENT OF INTERIOR
BUREAU OF LAND MANAGEMENT

CLAIM NAME/NUMBER INDEX

Case Disp Txt = ACTIVE

County: PINAL

<u>Claim Name/Number</u>	<u>Serial Number</u>	<u>Claimant(s)</u>	<u>Mer</u>	<u>Twn</u>	<u>Range</u>	<u>Sec</u>	<u>Subdiv</u>	<u>Location Date</u>	<u>Case Closed</u>
RIPSEY HILL N01 1994	AMC361425	DEEN GARY	14	0050S	0130E	012	NE,SE	04/06/2004	
			14	0050S	0140E	007	SW	04/06/2004	
		DEEN JOE	14	0050S	0130E	012	NE,SE	04/06/2004	
			14	0050S	0140E	007	SW	04/06/2004	
		DEEN RON	14	0050S	0130E	012	NE,SE	04/06/2004	
			14	0050S	0140E	007	SW	04/06/2004	
RIPSEY HILL NO. 2	AMC372554	DEEN RONALD SR	14	0050S	0130E	012	NE,SE	04/06/2004	
			14	0050S	0140E	007	SW	04/06/2004	
		DEEN GARY	14	0050S	0130E	012	SE	06/16/2006	
		DEEN JOE	14	0050S	0130E	012	SE	06/16/2006	
		DEEN RON	14	0050S	0130E	012	SE	06/16/2006	
		DEEN RONALD SR	14	0050S	0130E	012	SE	06/16/2006	
RIPSEY HILL NO. 7	AMC372555	DEEN TOM	14	0050S	0130E	012	SE	06/16/2006	
		DEEN GARY	14	0050S	0130E	012	SE	06/16/2006	
			14	0050S	0140E	007	SW	06/16/2006	
			14	0050S	0140E	018	NW	06/16/2006	
		DEEN JOE	14	0050S	0130E	012	SE	06/16/2006	
			14	0050S	0140E	007	SW	06/16/2006	
			14	0050S	0140E	018	NW	06/16/2006	
		DEEN RON	14	0050S	0130E	012	SE	06/16/2006	
			14	0050S	0140E	007	SW	06/16/2006	
			14	0050S	0140E	018	NW	06/16/2006	
		DEEN RONALD SR	14	0050S	0130E	012	SE	06/16/2006	
			14	0050S	0140E	007	SW	06/16/2006	
RIPSEY HILL NO3 1997	AMC376995	DEEN TOM	14	0050S	0130E	012	SE	06/16/2006	
			14	0050S	0140E	007	SW	06/16/2006	
			14	0050S	0140E	018	NW	06/16/2006	
		DEEN GARY	14	0050S	0130E	012	SE	12/20/2006	
		DEEN RON	14	0050S	0130E	012	SE	12/20/2006	
		DEEN RONALD SR	14	0050S	0130E	012	SE	12/20/2006	

DISCLOSURE ALL INFORMATION RECEIVED IN THIS OFFICE MAY NOT YET BE LISTED ON THIS REPORT. NAMES AND ADDRESSES ARE ENTERED AS THEY APPEAR ON THE LOCATION NOTICE OR ARE ABBREVIATED TO FIT LIMITED SPACE; THEREFORE, THEY MAY NOT APPEAR IN THE EXPECTED SEQUENCE. A BLANK LATEST ASSESSMENT YEAR IN THIS REPORT DOES NOT CONSTITUTE AN ABANDONED CLAIM.

AMC 348183
376993 360019
404144 348984
358030
361425
372553

September
01, 2014 ASSESSMENT YEAR, annual maintenance fee 2015
MAINTENANCE FEE PAYMENT

Claimant Name: DEEN / Tunnel Mine
Address: 56389 East Simmons Way
City: Kearny State: AZ Zip: 85137
Telephone: 520-363 5692
E-mail address: _____
Signature: Ronald Deen

RECEIVED
BLM AZ STATE OFFICE
2014 AUG 18 P 3:47
PHOENIX, ARIZONA
BLM
Date
Stamp

Check here if this is a change of address.

LINE NO.	AMC NUMBER	CLAIM/SITE NAME	COUNTY RECORDER DATA (If available)	TWP	RNG	SEC
1	404144	Black Eagle 2006	2011-004936	1S	12E	14
2						
3						
4						
5						
6						
7						
8						
9						
10						

June 30, 2014
v/sc List additional claims on Form MCF114.

Bureau of Land Management
Arizona State Office
www.blm.gov/az

No. of Claims: 1 x \$140 = 155⁰⁰/₁₀₀
Check No: 2011 Init. SC
Receipt No.: 3104884
For BLM Use Only

Receipt to Allen Joe, Ron, Gary

This form is available from the Arizona Department of Mines and Mineral Resources and may be reproduced.

Form: MCF117
Revised July 2009
ENTERED
SEP 04 2014
BY: AT



56389 E Simmons Way
Kearny, AZ 85137-6017

September
01, 2014 ASSESSMENT YEAR, annual maintenance fee 2015

MAINTENANCE FEE PAYMENT / FLORENCE MINE ①

09/07/09
Claimant Name: DEEN / THE VIEJO RELEGADO MINE ②
Address: 56389 East Simmons Way RIPSEY MINE ③
City: Kearny State: AZ Zip: 85237
Telephone: 520-363-5692

E-mail address: _____
Signature: Ronald Deen

Check here if this is a change of address.

RECEIVED
BLM AZ STATE OFFICE
PHOENIX, ARIZONA
2014 AUG 18 P 3:47

BLM
Date
Stamp

LINE NO.	AMC NUMBER	CLAIM/SITE NAME	COUNTY RECORDER DATA (if available)	TWP	RNG	SEC
1	361425	RIPSEY HILL No.1 1994	04/06/04	5S	13E	12/
2	372554	RIPSEY HILL No.2 1997	08/26/06	5S	13E	12
3	376995	RIPSEY HILL No.3 1997	01/12/07	5S	13E	12
4	376996	RIPSEY HILL No.4 1997	01/12/07	5S	13E	12
5	372555	RIPSEY HILL No.7 1997	06/26/06	5S	13E	12/
6						
7						
8						
9						
10						

1/50 June 30, 2014
List additional claims on Form MCF114.

No. of Claims: 5 x \$125 = 625 ¹⁵⁵ ~~140~~ ₇₇₅ ^{cc} ~~xx~~
Check No: 2011 Init. SC
Receipt No.: 3104884
For BLM Use Only

Bureau of Land Management
Arizona State Office
www.az.blm.gov

Paid by: receipt to Alan Joe Deen, Gary

Form: MCF112
Revised July 2005

This form is available from the Arizona Department of Mines and Mineral Resources and may be reproduced.



September
01, 2014 ASSESSMENT YEAR, annual maintenance fee 2015

MAINTENANCE FEE PAYMENT

Claimant Name: DEEN / THE H. H. H. MINE

Address: 56389 East Simmons Way

City: Kearny State: AZ Zip: 85137

Telephone: 520-363-5692

E-mail address: _____

Signature: Donald Deen

Check here if this is a change of address.

RECEIVED
BLM AZ STATE OFFICE
2014 AUG 18 P 3:46
PHOENIX, ARIZONA
BLM Date Stamp

LINE NO.	AMC NUMBER	CLAIM/SITE NAME	COUNTY RECORDER DATA (If available)	TWP	RNG	SEC
1	372553	TULAH (1982)	FEE No: 2006-090456	3S	13E	7
2	361428	Galena No. 1 1992	FEE Nos: 2004-024488	3S	13E	7SW/4
3						
4						
5						
6						
7						
8						
9						
10						

Due 30, 2014

List additional claims on Form MCF114.

2/SC

Bureau of Land Management
Arizona State Office
www.az.blm.gov

No. of Claims: 2 x ¹⁵⁵ \$125 = 310
 Check No: 2011 Init. SC
 Receipt No.: 3104884
 For BLM Use Only

Paid by receipt to Deen, Joe Don, Gary

Form: MCF112
Revised July 2005

This form is available from the Arizona Department of Mines and Mineral Resources and may be reproduced.

04/01/09
07/28/09

MAINTENANCE FEE PAYMENT

Claimant Name: (DIACARD) Jack Santella
 Address: 6237 E. Mallory
 City: NO SA State: AZ Zip: 85215
 Telephone: 480-830-2727
 E-mail address: AZJACK212@GMAIL.COM
 Signature: [Handwritten Signature]

Check here if this is a change of address.

RECEIVED
 IM AZ STATE OFFICE
 2011 AUG 18 P 3:46
 PHOENIX, ARIZONA
 BLM
 Date
 Stamp

LINE NO.	AMC NUMBER	CLAIM/SITE NAME	COUNTY RECORDER DATA (If available)	TWP	RNG	SEC
1	360019	Pin to Creek Mystery Mine		15	1NE	8
2						
3						
4						
5						
6						
7						
8						
9						
10						

List additional claims on Form MCF114.

Bureau of Land Management
 Arizona State Office
www.blm.gov/az/

No. of Claims: 1 x \$155 = 155
 Check No: 2011 Init. SC
 Receipt No.: 3104884
 For BLM Use Only

Form: MCF112
 Revised July 2009



September 01, 2014 / ASSESSMENT YEAR, annual maintenance fee 2015

MAINTENANCE FEE PAYMENT

Claimant Name: DEEN/SILVER KING MINE
Address: 56389 East Simmons Way
City: Kearny State: Az Zip: 85237
Telephone: 520-363-5692
E-mail address: _____
Signature: [Signature]

Check here if this is a change of address.

RECEIVED
BLM
Date Stamp
AZ STATE OFFICE
PHOENIX, ARIZONA
2014 AUG 18 P 3:46

LINE NO.	AMC NUMBER	CLAIM/SITE NAME	COUNTY RECORDER DATA (If available)	TWP	RNG	SEC
1	348183	EL MEDICO 2052	FEE No: 1997-035009	1S	12E	24
2	348186	SILVER KING 1997 #1	FEE No: 1997-035010	1S	12E	24
3	348187	SILVER KING 1997 #2	FEE No: 1997-035011	1S	12E	24
4	348188	SILVER KING 1997 #3	FEE No: 1997-035012	1S	12E	24
5	348984	SILVER KING SOUTH	FEE No: 1997-043840	1S	12E	24
6	348985	SILVER KING SW	FEE No: 1997-043839	1S	12E	24
7	358030	SILVER KING 1997	FEE No: 2003-040453	1S	12E	24
8	358031	SILVER KING 1997 #4	FEE No: 2003-040452	1S	12E	24
9	361426	SILVER KING 1997 #8	FEE No: 2004-024495	1S	12E	24
10	361427	SILVER KING 1997 #9	FEE No: 2004-024496	1S	12E	24

June 30 2014

List additional claims on Form MCF114.

No. of Claims: 10 x \$¹⁵⁵~~125~~ = 1,550.00
Check No: 2011 Init. SC
Receipt No.: 3104884
For BLM Use Only

10/50

Bureau of Land Management
Arizona State Office
www.az.blm.gov

Rec'd by receipt to Deen, Be, Ken, Gary

This form is available from the Arizona Department of Mines and Mineral Resources and may be reproduced.

Form: MCF112
Revised July 2005

04/01/09
07/28/09

United States Department of the Interior
Bureau of Land Management
 LANDS/RECREATION & PLANNING
 ONE N CENTRAL AVE
 PHOENIX, AZ 85004 -2203
 Phone: 602-417-9200

Receipt

No: 3104884

Transaction #: 3196490	
Date of Transaction: 08/18/2014	
CUSTOMER:	
RONALD R DEEN 56389 E SIMMONS WAY KEARNY, AZ 85237-6017 US	

LINE #	QTY	DESCRIPTION	REMARKS	UNIT PRICE	TOTAL
1	1.00	LOCATABLE MINERALS / MINING CLAIMS- NEW, UNADJUD, ONE OR MORE AUTH NOS / NEW MINING CLAIMS MAINTENANCE FEE CASES: AMC404144/\$2945.00	MAINT (19) 2015	- n/a -	2945.00
TOTAL:					\$2,945.00

PAYMENT INFORMATION					
1	AMOUNT:	2945.00	POSTMARKED:	N/A	
	TYPE:	CHECK	RECEIVED:	08/18/2014	
	CHECK NO:	2011			
	NAME:	SILVER KING MINING CO DEEN, RONALD R 56389 E SIMMONS WAY KEARNY AZ 85237-6017 US			

REMARKS

This receipt was generated by the automated BLM Collections and Billing System and is a paper representation of a portion of the official electronic record contained therein.



Mr. Ronald Deen
56389 E Simmons Way
Kearny, AZ 85137-6017

348183
348984
358030
361425
372553
376993

2013 ASSESSMENT YEAR

MAINTENANCE FEE PAYMENT

Claimant Name: DEEN/SILVER KING MINE
Address: 56389 East Simmons Way
City: Kearny State: AZ Zip: 85237
Telephone: 520-363-5692
E-mail address: _____
Signature: Ron Deen

RECEIVED
BLM
Date Stamp
PHOENIX, ARIZONA
2013 AUG 28 A 10:18
BLM STATE OFFICE

Check here if this is a change of address.

LINE NO.	AMC NUMBER	CLAIM/SITE NAME	COUNTY RECORDER DATA (if available)	TWP	RNG	SEC
1	348183	EL MEDICO 2052	FEE No: 1997-035009	1S	12E	24
2	348186	SILVER KING 1997 #1	FEE No: 1997-035010	1S	12E	24
3	348187	SILVER KING 1997 #2	FEE No: 1997-035011	1S	12E	24
4	348188	SILVER KING 1997 #3	FEE No: 1997-035012	1S	12E	24
5	348984	SILVER KING SOUTH	FEE No: 1997-043840	1S	12E	24
6	348985	SILVER KING SW	FEE No: 1997-043839	1S	12E	24
7	358030	SILVER KING 1997	FEE No: 2003-040453	1S	12E	24
8	358031	SILVER KING 1997 #4	FEE No: 2003-040452	1S	12E	24
9	361426	SILVER KING 1997 #8	FEE No: 2004-024495	1S	12E	24
10	361427 ⁴²	SILVER KING 1997 #9	FEE No: 2004-024496	1S	12E	24

List additional claims on Form MCF114.

Bureau of Land Management
Arizona State Office
www.az.blm.gov

No. of Claims: 10 x \$125 = 1400
Check No: 1851 Init. NCH
Receipt No.: 2867199
For BLM Use Only

Form: MCF112
Revised July 2005

This form is available from the Arizona Department of Mines and Mineral Resources and may be reproduced.

ENTERED
SEP - 9 2013
BY: RE

04/01/09
07/28/09



Mr. Ronald Deen
56389 E Simmons Way
Kearny, AZ 85137-6017

10

2013 ASSESSMENT YEAR

MAINTENANCE FEE PAYMENT/FLORENCE MINE

08/07/09
Claimant Name: DEEN / THE VIEJO RELEGADO MINE

Address: 56389 East Simmons Way

City: Kearny State: AZ Zip: 85237

Telephone: 520-363-5692

E-mail address: _____

Signature: Ronald Deen

Check here if this is a change of address.

BLM
Date
Stamp

2013 AUG 28 A 10:18

PHOENIX, ARIZONA

RECEIVED
BLM AZ STATE OFFICE

LINE NO.	AMC NUMBER	CLAIM/SITE NAME	COUNTY RECORDER DATA (If available)	TWP	RNG	SEC
1	361425	RIPSEY HILL No.1 1994	04/06/04	5S	13E	12/
2	372554	RIPSEY HILL No.2 1997	06/26/06	5S	13E	12
3	376995	RIPSEY HILL No.3 1997	01/12/07	5S	13E	12
4	376996	RIPSEY HILL No.4 1997	01/12/07	5S	13E	12
5	372555	RIPSEY HILL No.7 1997	06/26/06	5S	13E	12/
6	372553					
7						
8						
9						
10						

List additional claims on Form MCF114.

Bureau of Land Management
Arizona State Office
www.az.blm.gov

No. of Claims: 5 x ¹⁴⁰ \$125 = 700

Check No: 1851 Init. RCH

Receipt No.: 2867199

For BLM Use Only

Form: MCF112
Revised July 2005



Mr Ronald Deen
56389 E Simmons Way
Kearny, AZ 85237-6017

2013 ASSESSMENT YEAR

MAINTENANCE FEE PAYMENT

Claimant Name: DEEN / THE H.H.H. MINE

Address: 56389 East Simmons Way

City: Kearny State: AZ Zip: 85137

Telephone: 520-363-5692

E-mail address: _____

Signature: Ronald Deen

Check here if this is a change of address.

RECEIVED
BLM AZ STATE OFFICE
2013 AUG 28 A 10:18
PHOENIX, ARIZONA
BLM
Date
Stamp

LINE NO.	AMC NUMBER	CLAIM/SITE NAME	COUNTY RECORDER DATA (If available)	TWP	RNG	SEC
1	372553	Tuoh (1982)	FEE No: 2006-090526	3S	13E	7
2	361428	Galena No. 1 1992	FEE No: 2004-024488	3S	13E	7SW/4
3						
4						
5						
6						
7						
8						
9						
10						

List additional claims on Form MCF114.

Bureau of Land Management
Arizona State Office
www.az.blm.gov

No. of Claims: 2 x \$125 = 280
 Check No: 1851 Init. RD
 Receipt No.: 2867199
 For BLM Use Only

Form: MCF112
Revised July 2005

This form is available from the Arizona Department of Mines and Mineral Resources and may be reproduced.

04/01/09
07/28/09



Mr. Ronald Deen
56389 E Simmons Way
Kearny, AZ 85137-6017

2013 ASSESSMENT YEAR

MAINTENANCE FEE PAYMENT

Claimant Name: DEEN / Tunnel Mine

Address: 56389 East Simmons Way

City: Kearny State: Az zip: 85137

Telephone: 520-363 5692

E-mail address: _____

Signature: Ronald Deen

Check here if this is a change of address.

RECEIVED
 FILM AZ STATE OFFICE
 2013 AUG 28 A 10: 18
 PHOENIX, ARIZONA
 BLM
 Date
 Stamp

LINE NO.	AMC NUMBER	CLAIM/SITE NAME	COUNTY RECORDER DATA (If available)	TWP	RNG	SEC
1	404144	Black Eagle 2006	2011-004936	1S	12E	14
2						
3						
4						
5						
6						
7						
8						
9						
10						

List additional claims on Form MCF114.

Bureau of Land Management
Arizona State Office
www.blm.gov/az/

No. of Claims: 1 x \$140 = 140
 Check No: 1851 Init. RDH
 Receipt No.: 2867199
For BLM Use Only

MAINTENANCE FEE PAYMENT

Claimant Name: JACK SAN FELICE
 Address: 6237 E. MULLOBY ST
 City: MESA State: AZ Zip: 85215
 Telephone: 480-830-2727
 E-mail address: AZJACK212@GMAIL.COM
 Signature: Jack San Felice

Check here if this is a change of address.

RECEIVED
 BLM AZ STATE OFFICE
 PHOENIX, ARIZONA
 2013 AUG 28 A 10:18
 BLM
 Date
 Stamp

LINE NO.	AMC NUMBER	CLAIM/SITE NAME	COUNTY RECORDER DATA (If available)	TWP	RNG	SEC
1	360019	Pinto Creek Mystery Mine				
2						
3						
4						
5						
6						
7						
8						
9						
10						

List additional claims on Form MCF114.

Bureau of Land Management
 Arizona State Office
 www.blm.gov/az/

No. of Claims: 1 x \$140 = 140
 Check No: 1851 Init. MSH
 Receipt No.: 2867199
 For BLM Use Only

Form: MCF112
 Revised July 2009

United States Department of the Interior
Bureau of Land Management
 LANDS/RECREATION & PLANNING
 ONE N CENTRAL AVE
 PHOENIX, AZ 85004 -2203
 Phone: 602-417-9200

Receipt

No: 2867199

Transaction #: 2953138	
Date of Transaction: 08/28/2013	
CUSTOMER:	
RONALD R DEEN 56389 E SIMMONS WAY KEARNY, AZ 85237-6017 US	

LINE #	QTY	DESCRIPTION	REMARKS	UNIT PRICE	TOTAL
1	1.00	LOCATABLE MINERALS / MINING CLAIMS- NOT NEW-UNADJUD, ONE AUTH NO. ONLY / MINING CLAIM MONEY RECEIVED CASES: AMC348183/\$2660.00	MAINT (19) 2014	- n/a -	2660.00
TOTAL:					\$2,660.00

PAYMENT INFORMATION			
1	AMOUNT:	2660.00	POSTMARKED: N/A
	TYPE:	CHECK	RECEIVED: 08/28/2013
	CHECK NO:	1851	
	NAME:	DEEN, RONALD R 56389 E SIMMONS WAY KEARNY AZ 85237-6017 US	

REMARKS

This receipt was generated by the automated BLM Collections and Billing System and is a paper representation of a portion of the official electronic record contained therein.

AMC 348143
 AMC 348984
 AMC 358030
 AMC 361425
 AMC 372553
 AMC 376993
 AMC 404144

BLM
 AZ STATE OFFICE
 2012 JUN 14 P 1:45
 PHOENIX, ARIZONA

MAINTENANCE FEE PAYMENT

Claimant Name: DEEN / SILVER KING MINE
 Address: 56389 East Simmons Way
 City: Kearny State: AZ Zip: 85137
 Telephone: 520-363-5692
 E-mail address: _____
 Signature: Kay Deen

BLM
 Date
 Stamp

Check here if this is a change of address.

LINE NO.	AMC NUMBER	CLAIM/SITE NAME	COUNTY RECORDER DATA (If available)	TWP	RNG	SEC
1	348183	EL MEDICO 2052	Fee No. 1997-035009	1S	12E	24
2	348186	SILVER KING 1997 #1	Fee No. 1997-035010	1S	12E	24
3	348187	SILVER KING 1997 #2	Fee No. 1997-035011	1S	12E	24
4	348188	SILVER KING 1997 #3	Fee No. 1997-035012	1S	12E	24
5	348984	SILVER KING SOUTH	Fee No. 1997-043840	1S	12E	24
6	348985	SILVER KING SW	Fee No. 1997-043839	1S	12E	24
7	358030	SILVER KING 1997	Fee No. 2003-040453	1S	12E	24
8	358031	SILVER KING 1997 #4	Fee No. 2003-040452	1S	12E	24
9	361426	SILVER KING 1997 #8	Fee No. 2004-024495	1S	12E	24
10	361427	SILVER KING 1997 #9	Fee No. 2004-024496	1S	12E	24

List additional claims on Form MCF114.

Bureau of Land Management
 Arizona State Office
 www.blm.gov/az/

No. of Claims: 18 x \$140 = 2,520
 Check No: 1658 Init. JMC
 Receipt No.: 2630368
 For BLM Use Only

Form: MCF112
 Revised July 2009

This form is available from the Arizona Department of Mines and Mineral Resources and may be reproduced.

ENTERED IN COMPUTER

RE 8-22-12

MAINTENANCE FEE PAYMENT ^①/FLORENCE MINE

Claimant Name: DEEN ^②/THE VIEJO RELEGAD MINE

Address: 56389 East STIMMONS Way ^③/RIPSEY MINE

City: Kearny State: Az Zip: 85137

Telephone: 520-363-5692

E-mail address: _____

Signature: Donald Deen

Check here if this is a change of address.

RECEIVED
 BLM AZ STATE OFFICE
 2012 AUG 14 P 1:45
 PHOENIX, ARIZONA
 BLM
 Date
 Stamp

LINE NO.	AMC NUMBER	CLAIM/SITE NAME	COUNTY RECORDER DATA (If available)	TWP	RNG	SEC
1	⁴²⁵ 361(425)	RIPSEY HILL No.1 1994	04/06/04	5S	13E	12/
2	372554	RIPSEY HILL No.2 1997	06/26/06	5S	13E	12
3	376995	RIPSEY HILL No.3 1997	01/12/07	5S	13E	12
4	376996	RIPSEY HILL No.4 1997	01/12/07	5S	13E	12
5	372555	RIPSEY HILL No.7 1997	06/26/06	5S	13E	12/
6						
7						
8						
9						
10						

List additional claims on Form MCF114.

Bureau of Land Management
Arizona State Office
www.blm.gov/az/

No. of Claims: _____ x \$140 = _____
 Check No: _____ Init. _____
 Receipt No.: _____
For BLM Use Only

Form: MCF112
 Revised July 2009

This form is available from the Arizona Department of Mines and Mineral Resources and may be reproduced.

MAINTENANCE FEE PAYMENT

Claimant Name: DEEN / Tunnel Mine
 Address: 56389 East Simmons Way
 City: Kearny State: Az Zip: 85137
 Telephone: 520-363 5692
 E-mail address: _____
 Signature: Ronald Deen

Check here if this is a change of address.

RECEIVED
 BLM
 AZ STATE OFFICE
 2012 AUG 14 P 1:45
 PHOENIX, ARIZONA
 BLM
 Date
 Stamp

LINE NO.	AMC NUMBER	CLAIM/SITE NAME	COUNTY RECORDER DATA (If available)	TWP	RNG	SEC
1	404144	Black Eagle 2006	2011-004936	1S	12E	14
2						
3						
4						
5						
6						
7						
8						
9						
10						

List additional claims on Form MCF114.

Bureau of Land Management
Arizona State Office
www.blm.gov/az/

No. of Claims: _____ x \$140 = _____
 Check No: _____ Init. _____
 Receipt No.: _____
For BLM Use Only

Form: MCF112
 Revised July 2009

MAINTENANCE FEE PAYMENT

Claimant Name: DEEN / THE H.H.H. MINE
 Address: 56389 East Simmons Way
 City: Kearny State: Az Zip: 85137
 Telephone: 520-363-5692
 E-mail address: _____
 Signature: *Ronald Deen*

Check here if this is a change of address.

RECEIVED
 BLM AZ STATE OFFICE
 2012 AUG 14 P 1:45
 PHOENIX, ARIZONA
 BLM
 Date
 Stamp

LINE NO.	AMC NUMBER	CLAIM/SITE NAME	COUNTY RECORDER DATA (If available)	TWP	RNG	SEC
1	372553	JUAN (1982)	Fee No. 2006-090456	3S	13E	7
2	361428	GALENA No. 1 1992	Fee No. 2004-024488	3S	13E	7SW 1/4
3						
4						
5						
6						
7						
8						
9						
10						

List additional claims on Form MCF114.

**Bureau of Land Management
 Arizona State Office**
www.blm.gov/az/

No. of Claims: _____ x \$140 = _____
 Check No: _____ Init. _____
 Receipt No.: _____
For BLM Use Only

Form: MCF112
 Revised July 2009

United States Department of the Interior
Bureau of Land Management
 LANDS/RECREATION & PLANNING
 ONE N CENTRAL AVE
 PHOENIX, AZ 85004 -2203
 Phone: 602-417-9200

Receipt

No:

2630368

Transaction #: 2710857	
Date of Transaction: 08/14/2012	
CUSTOMER:	
SILVER KING MINING COMPANY OF ARIZONA LLC 56389 E SIMMONS WAY KEARNY, AZ 85137-6017 US	

LINE #	QTY	DESCRIPTION	REMARKS	UNIT PRICE	TOTAL
1	1.00	LOCATABLE MINERALS / MINING CLAIMS-NOT NEW-UNADJUD, ONE AUTH NO. ONLY / MINING CLAIM MONEY RECEIVED CASES: AMC348183/\$2520.00	MAINT 2013/18	- n/a -	2520.00
TOTAL:					\$2,520.00

PAYMENT INFORMATION			
1	AMOUNT:	2520.00	POSTMARKED: N/A
	TYPE:	CHECK	RECEIVED: 08/14/2012
	CHECK NO:	1658	
	NAME:	SILVER KING MINING COMPANY OF ARIZONA LLC 56389 E SIMMONS WAY KEARNY AZ 85137-6017 US	

REMARKS

This receipt was generated by the automated BLM Collections and Billing System and is a paper representation of a portion of the official electronic record contained therein.

Amc 361425
 Amc 372553
 Amc 376993
 Amc 404144
 Amc 360019
 Amc 348183
 Amc 348984

Amc 358030

MAINTENANCE FEE PAYMENT

Claimant Name: DEEN/SILVER KING MINE
 Address: 56389 Edst Simmons Way
 City: Kearny State: AZ Zip: 85137
 Telephone: 520-363-5692
 E-mail address: _____
 Signature: [Signature]
 Check here if this is a change of address.

RECEIVED
 BLM AZ STATE OFFICE
 2011 AUG 18 A 11:21
 PHOENIX, ARIZONA
 BLM
 Date
 Stamp

LINE NO.	AMC NUMBER	CLAIM/SITE NAME	COUNTY RECORDER DATA (If available)	TWP	RNG	SEC
✓ 1	348183	EL MEDICO 2052	Fee No. 1997-035009	1S	12E	24
✓ 2	348186	SILVER KING 1997*1	Fee No. 1997-035010	1S	12E	24
✓ 3	348187	SILVER KING 1997*2	Fee No. 1997-035011	1S	12E	24
✓ 4	348188	SILVER KING 1997*3	Fee No. 1997-035012	1S	12E	24
✓ 5	348984	SILVER KING SOUTH	Fee No. 1997-043840	1S	12E	24
✓ 6	348985	SILVER KING SW	Fee No. 1997-043839	1S	12E	24
✓ 7	358030	SILVER KING 1997	Fee No. 2003-040453	1S	12E	24
✓ 8	358031	SILVER KING 1997*4	Fee No. 2003-040452	1S	12E	24
✓ 9	361426	SILVER KING 1997*8	Fee No. 2004-024475	1S	12E	24
✓ 10	361427	SILVER KING 1997*9	Fee No. 2004-024476	1S	12E	24

List additional claims on Form MCF114.

No. of Claims: 10 x \$140 = 1,400.00
 Check No: 1358 Init. SC
 Receipt No.: 2408414
 For BLM Use Only

Bureau of Land Management
 Arizona State Office
 www.blm.gov/az/

AUG 30 2011

Form: MCF112
 Revised July 2009

MAINTENANCE FEE PAYMENT / FLORENCE MINE

Claimant Name: DFEN / THE VIEJO RELEGAD MINE
 Address: 56389 East Simmons Way
 City: Kearny State: AZ Zip: 85137
 Telephone: 520-363-5692
 E-mail address: _____
 Signature: *Donald Allen*

RECEIVED
 BLM AZ STATE OFFICE
 2011 AUG 18 A 11:21
 PHOENIX, ARIZONA
 BLM
 Date
 Stamp

Check here if this is a change of address.

LINE NO.	AMC NUMBER	CLAIM/SITE NAME	COUNTY RECORDER DATA (If available)	TWP	RNG	SEC
✓ 1	361424 361424	RIPSEY HILL No. 1	1994 04/06/04	5S	13E	12/
✓ 2	372554	RIPSEY HILL No. 2	1997 06/26/06	5S	13E	12
✓ 3	376995	RIPSEY HILL No. 3	1997 01/12/07	5S	13E	12
✓ 4	376996	RIPSEY HILL No. 4	1997 01/12/07	5S	13E	12
✓ 5	372555	RIPSEY HILL No. 7	1997 06/26/06	5S	13E	12/
6						
7						
8						
9						
10						

List additional claims on Form MCF114.

Bureau of Land Management
Arizona State Office
 www.blm.gov/az/

No. of Claims: 5 x \$140 = 700
 Check No: 1358 Init. SC
 Receipt No.: 2408414
For BLM Use Only

Form: MCF112
 Revised July 2009

MAINTENANCE FEE PAYMENT

Claimant Name: DEEN / THE H.H.H. MINE
 Address: 56389 East Simmons Way
 City: Kearny State: AZ Zip: 85137
 Telephone: 520-363-5692
 E-mail address: _____
 Signature: *Donald Deen*

Check here if this is a change of address.

RECEIVED
 ARIZONA STATE OFFICE
 2011 AUG 18 A 11: 21
 PHOENIX, ARIZONA
 BLM
 Date
 Stamp

LINE NO.	AMC NUMBER	CLAIM/SITE NAME	COUNTY RECORDER DATA (If available)	TWP	RNG	SEC
✓ 1	372553	Juan (1982)	Fee No. 2006-090456	3S	13E	7
✓ 2	361428	Golden No. 1 1992	Fee No. 2004-024488	3S	13E	DSW/4
3						
4						
5						
6						
7						
8						
9						
10						

List additional claims on Form MCF114.

No. of Claims: 2 x \$140 = 280
 Check No: 1358 Init. SC
 Receipt No.: 2408414
 For BLM Use Only

Bureau of Land Management
 Arizona State Office
 www.blm.gov/az/

Form: MCF112
 Revised July 2009

MAINTENANCE FEE PAYMENT

Claimant Name: DEEN/ Tunnel Mine
 Address: 56389 E. Simmons Way
 City: Kearny State: AZ Zip: 85137
 Telephone: 520-363-5692
 E-mail address: _____
 Signature: [Signature]

Check here if this is a change of address.

RECEIVED
 PLM/AZ STATE OFFICE
 2011 AUG 18 A 11: 21
 PHOENIX, ARIZONA
 BLM
 Date
 Stamp

LINE NO.	AMC NUMBER	CLAIM/SITE NAME	COUNTY RECORDER DATA (If available)	TWP	RNG	SEC
✓ 1	404144	Black Eagle 2006		1S	12E	14
2						
3						
4						
5						
6						
7						
8						
9						
10						

List additional claims on Form MCF114.

Bureau of Land Management
Arizona State Office
 www.blm.gov/az/

No. of Claims: 1 x \$140 = 140
 Check No: 1358 Init. SC
 Receipt No.: 2408414
For BLM Use Only

Form: MCF112
 Revised July 2009

MAINTENANCE FEE PAYMENT

Claimant Name: Jack Sam Felice
 Address: 6237 E Mallowy
 City: Mesa State: Az Zip: 85245
 Telephone: 480-830-2227
 E-mail address: Az Jack Sam Felice Yahoo.C
 Signature: Jack Sam Felice

Check here if this is a change of address.

RECEIVED
 BLM ARIZONA STATE OFFICE
 PHOENIX, ARIZONA
 2011 AUG 18 A 11: 20
 BLM Date Stamp

LINE NO.	AMC NUMBER	CLAIM/SITE NAME	COUNTY RECORDER DATA (If available)	TWP	RNG	SEC
✓ 1	360019	Pinto Creek Mystery Mine		15	14	8
2						
3						
4						
5						
6						
7						
8						
9						
10						

List additional claims on Form MCF114.

Bureau of Land Management
 Arizona State Office
 www.blm.gov/az/

No. of Claims: 1 x \$140 = 140
 Check No: 1358 Init. SC
 Receipt No.: 2408414
 For BLM Use Only

Form: MCF112
 Revised July 2009

United States Department of the Interior
 Bureau of Land Management
 LANDS/RECREATION & PLANNING
 ONE N CENTRAL AVE
 PHOENIX, AZ 85004 -2203
 Phone: 602-417-9200

Receipt

No: 2408414

Transaction #: 2483712	
Date of Transaction: 08/18/2011	
CUSTOMER:	
JACK SAN FELICE 6237 E MALLORY ST MESA, AZ 85215-2116 US	

LINE #	QTY	DESCRIPTION	REMARKS	UNIT PRICE	TOTAL
1	1.00	LOCATABLE MINERALS / MINING CLAIMS-NOT NEW-UNADJUD, ONE AUTH NO. ONLY / MINING CLAIM MONEY RECEIVED CASES: AMC360019/\$2660.00	MAINT (19) 2012	- n/a -	2660.00
TOTAL:					\$2,660.00

PAYMENT INFORMATION			
1	AMOUNT:	2660.00	POSTMARKED: N/A
	TYPE:	CHECK	RECEIVED: 08/18/2011
	CHECK NO:	1358	
	NAME:	SAN FELICE, JACK 6237 E MALLORY ST MESA AZ 85215-2116 US	

REMARKS

This receipt was generated by the automated BLM Collections and Billing System and is a paper representation of a portion of the official electronic record contained therein.



MR. RONALD DEEN
56389 E. Simmons Way
Kearny, AZ 85137

AMC 358030

AMC 348183

AMC 348984

AMC 361425

ASSESSMENT

MAINTENANCE FEE PAYMENT

Claimant Name: DEEN/SILVER KING MINE

Address: 56389 East Simmons Way ✓

City: Kearny State: AZ Zip: 85237

Telephone: 520-363-5692

E-mail address: _____

Signature: Ron Deen

Check here if this is a change of address.

RECEIVED
BLM AZ STATE OFFICE
PHOENIX, ARIZONA
200 AUG - 3 P 3:45
BLM
Date
Stamp

LINE NO.	AMC NUMBER	CLAIM/SITE NAME	COUNTY RECORDER DATA (If available)	TWP	RNG	SEC
1	348183	EL MEDICO 2052	FEE No: 1997-035009	1S	12E	24
2	348186	SILVER KING 1997 #1	FEE No: 1997-035010	1S	12E	24
3	348187	SILVER KING 1997 #2	FEE No: 1997-035011	1S	12E	24
4	348188	SILVER KING 1997 #3	FEE No: 1997-035012	1S	12E	24
5	348984	SILVER KING SOUTH	FEE No: 1997-043840	1S	12E	24
6	348985	SILVER KING SW	FEE No: 1997-043839	1S	12E	24
7	358030	SILVER KING 1997	FEE No: 2003-040453	1S	12E	24
8	358031	SILVER KING 1997 #4	FEE No: 2003-040452	1S	12E	24
9	361426	SILVER KING 1997 #8	FEE No: 2004-024495	1S	12E	24
10	361427	SILVER KING 1997 #9	FEE No: 2004-024496	1S	12E	24

List additional claims on Form MCF114.

No. of Claims: 10 x \$125 = 1400
 Check No: 1162 Init. ERD
 Receipt No.: 2183126
 For BLM Use Only

Bureau of Land Management
Arizona State Office
www.az.blm.gov

Form: MCF112
Revised July 2005

This form is available from the Arizona Department of Mines and Mineral Resources and may be reproduced.

04/01/09
07/28/09

ENTERED INTO COMPUTER AUG 1 2 2010

United States Department of the Interior
Bureau of Land Management
 LANDS/RECREATION & PLANNING
 ONE N CENTRAL AVE
 PHOENIX, AZ 85004 -2203
 Phone:

Receipt

No: 2183126

Transaction #: 2252757		ENTERED INTO COMPUTER
Date of Transaction: 08/03/2010		
CUSTOMER:	RONALD R DEEN 56389 E SIMMONS WAY ✓ KEARNY, AZ 85237-6017 US	AUG 12 2010

LINE #	QTY	DESCRIPTION	REMARKS	UNIT PRICE	TOTAL
1	1.00	LOCATABLE MINERALS / MINING CLAIMS- NOT NEW-UNADJUD, ONE AUTH NO. ONLY / MINING CLAIM MONEY RECEIVED CASES: AMC348183/\$1400.00	<i>200</i> 2011 MAINT (10)	- n/a -	1400.00
TOTAL:					\$1,400.00

PAYMENT INFORMATION			
1	AMOUNT:	1400.00	POSTMARKED: N/A
	TYPE:	CHECK	RECEIVED: 08/03/2010
	CHECK NO:	1162	
	NAME:	DEEN, RONALD R 56389 E SIMMONS WAY KEARNY AZ 85237-6017 US	

REMARKS

This receipt was generated by the automated BLM Collections and Billing System and is a paper representation of a portion of the official electronic record contained therein.



Mr Ronald Deen
56389 E Simmons Way
Kearny, AZ 85237-6017

AMC 36142
37255
37699
34818
348984
358030

2010 ASSESSMENT YEAR

MAINTENANCE FEE PAYMENT

08/07/09

Claimant Name: DEEN / THE H. H. H. MINE

Address: 56389 East Simmons Way

City: Kearny State: AZ Zip: 85137

Telephone: 520-363-5692

E-mail address: _____

Signature: Ronald Deen

Check here if this is a change of address.

RECEIVED
 ILM AZ STATE OFFICE
 2009 AUG 25 P 1:36
 PHOENIX, ARIZONA
 BLM
 Date
 Stamp

2/50
40

LINE NO.	AMC NUMBER	CLAIM/SITE NAME	COUNTY RECORDER DATA (If available)	TWP	RNG	SEC
1	372553	Tuan (1982)	FEE No: 2006-090456	3S	13E	7
2	361428	Galena No. 1 1992	FEE No: 2004-024488	3S	13E	7SW 1/4
3						
4						
5						
6						
7						
8						
9						
10						

List additional claims on Form MCF114.

No. of Claims: 2 x \$125 = 280
 Check No: 1038 Init. SC
 Receipt No.: 1986790
 For BLM Use Only

Bureau of Land Management
Arizona State Office
www.az.blm.gov

Form: MCF112
Revised July 2005

This form is available from the Arizona Department of Mines and Mineral Resources and may be reproduced.

04/01/09
07/28/09



Mr Ronald Deen
56389 E Simmons Way
Kearny, AZ 85237-6017

2010 ASSESSMENT YEAR

MAINTENANCE FEE PAYMENT/FLORENCE MINE

Claimant Name: DEEN / THE VIEJO RELEGADO MINE

Address: 56389 East Simmons Way

City: Kearny State: AZ Zip: 85237

Telephone: 520-363-5692

E-mail address: _____

Signature: Ronald Deen

Check here if this is a change of address.

RECEIVED
BLM STATE OFFICE
2009 AUG 25 P 1:36
PHOENIX, ARIZONA

BLM
Date
Stamp

LINE NO.	AMC NUMBER	CLAIM/SITE NAME	COUNTY RECORDER DATA (if available)	TWP	RNG	SEC
5/5 ✓ 1	361425	RIPSEY HILL No. 1 1994	04/06/04	5S	13E	12/
✓ 2	372554	RIPSEY HILL No. 2 1997	06/26/06	5S	13E	12
✓ 3	376995	RIPSEY HILL No. 3 1997	01/12/07	5S	13E	12
4	376996	RIPSEY HILL No. 4 1997	01/12/07	5S	13E	12
✓ 5	372555	RIPSEY HILL No. 7 1997	06/26/06	5S	13E	12/
6						
7						
8						
9						
10						

List additional claims on Form MCF114.

Bureau of Land Management
Arizona State Office
www.az.blm.gov

No. of Claims: 5 x \$125 = \$700.00
 Check No: 1038 Init. SC
 Receipt No.: 1986790
 For BLM Use Only

Form: MCF112
Revised July 2005

This form is available from the Arizona Department of Mines and Mineral Resources and may be reproduced.

04/01/09
07/28/09



Mr Ronald Deen
56389 E Simmons Way
Kearny, AZ 85237-6017

MAINTENANCE FEE PAYMENT 2010 assessment year

08/07/09

Claimant Name: DEEN/SILVER KING MINE

Address: 56389 East Simmons Way

City: Kearny State: AZ Zip: 85237

Telephone: 520-363-5692

E-mail address: _____

Signature: Ron Deen

Check here if this is a change of address.

RECEIVED
 LIMA STATE OFFICE
 PHOENIX, ARIZONA
 2009 AUG 25 P 1:36
 BLM
 Date
 Stamp

LINE NO.	AMC NUMBER	CLAIM/SITE NAME	COUNTY RECORDER DATA (if available)	TWP	RNG	SEC
1 ✓	348183	EL MEDICO 2052	FEE No: 1997-035009	1S	12E	24
2 ✓	348186	SILVER KING 1997 #1	FEE No: 1997-035010	1S	12E	24
3 ✓	348187	SILVER KING 1997 #2	FEE No: 1997-035011	1S	12E	24
4 ✓	348188	SILVER KING 1997 #3	FEE No: 1997-035012	1S	12E	24
5 ✓	348984	SILVER KING SOUTH	FEE No: 1997-043840	1S	12E	24
6 ✓	348985	SILVER KING SW	FEE No: 1997-043839	1S	12E	24
7 ✓	358030	SILVER KING 1997	FEE No: 2003-040453	1S	12E	24
8 ✓	358031	SILVER KING 1997 #4	FEE No: 2003-040452	1S	12E	24
9 ✓	361426	SILVER KING 1997 #8	FEE No: 2004-024495	1S	12E	24
10 ✓	361427	SILVER KING 1997 #9	FEE No: 2004-024496	1S	12E	24

List additional claims on Form MCF114.

Bureau of Land Management
Arizona State Office
www.az.blm.gov

No. of Claims: 10 x \$125 = \$1,400.00
 Check No: 1038 Init. SC
 Receipt No.: 1986790
 For BLM Use Only

Form: MCF112
Revised July 2005

This form is available from the Arizona Department of Mines and Mineral Resources and may be reproduced.

04/01/09
07/28/09

United States Department of the Interior
Bureau of Land Management
 BUSINESS & SUPPORT SVCS DIV
 ONE N CENTRAL AVE SUITE 800
 PHOENIX, AZ 85004 -4427
 Phone: (602) 417-9200

Receipt

No: 1986790

Transaction #: 2050949	
Date of Transaction: 08/25/2009	
CUSTOMER:	RONALD R DEEN 56389 E SIMMONS WAY KEARNY, AZ 85237-6017 US

LINE #	QTY	DESCRIPTION	REMARKS	UNIT PRICE	TOTAL
1	1.00	LOCATABLE MINERALS / MINING CLAIMS-NOT NEW-UNADJUD, ONE AUTH NO. ONLY / MINING CLAIM MONEY RECEIVED CASES: AMC348183/\$2380.00	MAINT 2010 (17)	- n/a -	2380.00
TOTAL:					\$2,380.00

PAYMENT INFORMATION					
1	AMOUNT:	2380.00	POSTMARKED:	N/A	
	TYPE:	CHECK	RECEIVED:	08/25/2009	
	CHECK NO:	1038			
	NAME:	DEEN, RONALD R 56389 E SIMMONS WAY KEARNY AZ 85237-6017 US			

REMARKS

This receipt was generated by the automated BLM Collections and Billing System and is a paper representation of a portion of the official electronic record contained therein.

Donald Deen
 56389 East Simmons Way
 Kearny, Az 85237
 07/28/08

Amc 348183
 348984
 358030
 361425
 372553
 376993

MAINTENANCE FEE PAYMENT

BUREAU OF LAND MANAGEMENT
 222 N CENTRAL AVENUE
 PHOENIX, AZ 85004
 602-417-9200
 www.az.blm.gov

BLM DATE STAMP
 2008 JUL 31 A 7:15
 PHOENIX, ARIZONA

Mining Claim Maintenance Fee Payment of \$125 per claim/site is due on or before September 1, 2008, in lieu of assessment work for the upcoming assessment year beginning September 1 of the year noted above.

Line No.	AMC NUMBER	CLAIM/SITE NAME
1	348183	EL MEDICO 2052
2	348186	SILVER KING 1997 #1
3	348187	SILVER KING 1997 #2
4	348188	SILVER KING 1997 #3
5	348984	SILVER KING SOUTH
6	348985	SILVER KING SW
7	358030	SILVER KING 1997
8	358031	SILVER KING 1997 #4
9	361426	SILVER KING 1997 #8
10	361427	SILVER KING 1997 #9

List additional claims on the reverse side of this form.
 Check here if this is a change of address.

CLAIMANT NAME: THE SILVER KING MINE/Deen
 ADDRESS: 56389 East Simmons Way
 CITY: Kearny STATE: AZ ZIP: 85237
 PHONE: 520-363-5692
 SIGNATURE: Donald Deen

No of Claims: 19 x \$125 = 2375
 Payment Type: check Init: SPR
 Receipt No: 1751454 Phone Submission _____
 Date Entered into Computer: AUG 07 2008
 Initials: pb Verified: yes (pb)
ENTERED INTO COMPUTER
 FOR BLM USE ONLY

Claimant or agent must sign to record with the County.

Line No.	AMC NUMBER	CLAIM/SITE NAME
11		
12		
13		
14		
15		

PHOENIX, ARIZONA
 JUN 31 A 7 15
 2005

The names and current addresses of all owners should be identified on all instruments to be recorded or filed.

Name: _____ Address: _____
 City: _____ State: _____ Zip: _____ Change of address

Name: _____ Address: _____
 City: _____ State: _____ Zip: _____ Change of address

Name: _____ Address: _____
 City: _____ State: _____ Zip: _____ Change of address

Name: _____ Address: _____
 City: _____ State: _____ Zip: _____ Change of address

Name: _____ Address: _____
 City: _____ State: _____ Zip: _____ Change of address

Name: _____ Address: _____
 City: _____ State: _____ Zip: _____ Change of address

Name: _____ Address: _____
 City: _____ State: _____ Zip: _____ Change of address

Name: _____ Address: _____
 City: _____ State: _____ Zip: _____ Change of address

PRIVACY ACT STATEMENT – This information is being collected pursuant to 30 U.S.C. 28, 43 CFR 3833.2, and ARS 27-208 in compliance with the laws of the USDI, Bureau of Land Management, and the State of Arizona. The purpose of this collection is to facilitate processing of claims or applications. This form is covered by Privacy Act Notice #INTERIOR/LLM -32 and is subject to the routine uses stated in that notice. Privacy Act Notice #INTERIOR/LLM-32 is available at the BLM Arizona State Office. This form may be locally reproduced.

Ronald Deen
 56389 East Simmons Way
 Kearny, Az. 85237
 07/29/08

MAINTENANCE FEE PAYMENT

BUREAU OF LAND MANAGEMENT
 222 N CENTRAL AVENUE
 PHOENIX, AZ 85004
 602-417-9200
 www.az.blm.gov

BLM DATE STAMP
 AUG 31 A 7:15
 PHOENIX, ARIZONA

Mining Claim Maintenance Fee Payment of \$125 per claim/site is due on or before September 1, 2008, in lieu of assessment work for the upcoming assessment year beginning September 1 of the year noted above.

Line No.	AMC NUMBER	CLAIM/SITE NAME
1	37255.3	Juan (1982)
2	361428	Galena Nat 1992
3		
4		
5		
6		
7		
8		
9		
10		

List additional claims on the reverse side of this form.

Check here if this is a change of address.

CLAIMANT NAME: THE H.H.H. NINE / Deen
 ADDRESS: 56389 East Simmons Way
 CITY: Kearny STATE: AZ ZIP: 85237
 PHONE: 520-363-5692
 SIGNATURE: Ronald Deen

(2)

No of Claims: _____	x \$125 = _____
Payment Type: _____	Init: _____
Receipt No: _____	Phone Submission _____
Date Entered Into Computer <u>AUG 07 2008</u>	
Initials: <u>RB</u>	Verified: <u>RB</u>

FOR BLM USE ONLY

Claimant or agent must sign to record with the County.

Line No.	AMC NUMBER	CLAIM/SITE NAME
11		
12		
13		
14		
15		

PHOENIX, ARIZONA
 SEP 31 A 7:15

The names and current addresses of all owners should be identified on all instruments to be recorded or filed.

Name: _____ Address: _____
 City: _____ State: _____ Zip: _____ Change of address

Name: _____ Address: _____
 City: _____ State: _____ Zip: _____ Change of address

Name: _____ Address: _____
 City: _____ State: _____ Zip: _____ Change of address

Name: _____ Address: _____
 City: _____ State: _____ Zip: _____ Change of address

Name: _____ Address: _____
 City: _____ State: _____ Zip: _____ Change of address

Name: _____ Address: _____
 City: _____ State: _____ Zip: _____ Change of address

Name: _____ Address: _____
 City: _____ State: _____ Zip: _____ Change of address

Name: _____ Address: _____
 City: _____ State: _____ Zip: _____ Change of address

PRIVACY ACT STATEMENT – This information is being collected pursuant to 30 U.S.C. 28, 43 CFR 3833.2, and ARS 27-208 in compliance with the laws of the USD, Bureau of Land Management, and the State of Arizona. The purpose of this collection is to facilitate processing of claims or applications. This form is covered by Privacy Act Notice #INTERIOR/LLM -32 and is subject to the routine uses stated in that notice. Privacy Act Notice #INTERIOR/LLM-32 is available at the BLM Arizona State Office. This form may be locally reproduced.

Florida Deen
 56389 East Simmons Way
 Kearny, AZ 85237
 07/28/08

MAINTENANCE FEE PAYMENT

BUREAU OF LAND MANAGEMENT
 222 N CENTRAL AVENUE
 PHOENIX, AZ 85004
 602-417-9200
 www.az.blm.gov

BLM DATE STAMP
 PHOENIX, ARIZONA
 2008 JUL 31 A 7:15

Mining Claim Maintenance Fee Payment of \$125 per claim/site is due on or before September 1, 2008, in lieu of assessment work for the upcoming assessment year beginning September 1 of the year noted above.

Line No.	AMC NUMBER	CLAIM/SITE NAME
1	376993	Black Eagle 2006 Lode
2	376994	Crescent 2006 Lode
3		
4		
5		
6		
7		
8		
9		
10		

List additional claims on the reverse side of this form.

Check here if this is a change of address.

CLAIMANT NAME: THE VEIN MINE / Deen
 ADDRESS: 56389 East Simmons Way
 CITY: Kearny STATE: AZ ZIP: 85237
 PHONE: 520-363-5692
 SIGNATURE: Florida Deen

(2)

No of Claims: _____	x \$125 = _____
Payment Type: _____	Init: _____
Receipt No: _____	Phone Submission _____
Date Entered Into Computer <u>AUG 07 2008</u>	
Initials: <u>FD</u>	Verified: <u>FD</u>

FOR BLM USE ONLY

Claimant or agent must sign to record with the County.

Line No.	AMC NUMBER	CLAIM/SITE NAME
11		
12		
13		
14		
15		

PHOENIX, ARIZONA
 JUN 31 A 1:00 PM '06

The names and current addresses of all owners should be identified on all instruments to be recorded or filed.

Name: _____ Address: _____
 City: _____ State: _____ Zip: _____ *Change of address*

Name: _____ Address: _____
 City: _____ State: _____ Zip: _____ *Change of address*

Name: _____ Address: _____
 City: _____ State: _____ Zip: _____ *Change of address*

Name: _____ Address: _____
 City: _____ State: _____ Zip: _____ *Change of address*

Name: _____ Address: _____
 City: _____ State: _____ Zip: _____ *Change of address*

Name: _____ Address: _____
 City: _____ State: _____ Zip: _____ *Change of address*

Name: _____ Address: _____
 City: _____ State: _____ Zip: _____ *Change of address*

Name: _____ Address: _____
 City: _____ State: _____ Zip: _____ *Change of address*

PRIVACY ACT STATEMENT – This information is being collected pursuant to 30 U.S.C. 28, 43 CFR 3833.2, and ARS 27-208 in compliance with the laws of the USDI, Bureau of Land Management, and the State of Arizona. The purpose of this collection is to facilitate processing of claims or applications. This form is covered by Privacy Act Notice #INTERIOR/LLM -32 and is subject to the routine uses stated in that notice. Privacy Act Notice #INTERIOR/LLM-32 is available at the BLM Arizona State Office. This form may be locally reproduced.

Ronald Ueen
 56389 East Simmons Way
 Kearny, AZ 85237
 07/28/08

MAINTENANCE FEE PAYMENT

BUREAU OF LAND MANAGEMENT
 222 N CENTRAL AVENUE
 PHOENIX, AZ 85004
 602-417-9200
 www.az.blm.gov

Mining Claim Maintenance Fee Payment of \$125 per claim/site is due on or before September 1, 2008, in lieu of assessment work for the upcoming assessment year beginning September 1 of the year noted above.

PHOENIX, ARIZONA
 JUN 31 A 7 15
 BLM Date Stamp

AMC NUMBER	CLAIM/SITE NAME	COUNTY RECORDER	SEC	TWP	RNG
361425	RIPSEY HILL No. 1 1994	DATA 04/06/04	12	5S	13E
372554	RIPSEY HILL No. 2 1997	06/26/06	12	5S	13E
372555	RIPSEY HILL No. 7 1997	06/26/06	12	5S	13E
376995	RIPSEY HILL No. 3 1997	01/12/07	12	5	13E
376996	RIPSEY HILL No. 4 1997	01/12/07	12	5	13E
ENTERED INTO COMPUTER					
AUG 07 2008 RB					

List additional claims on the reverse side of this form.

Check here if this is a change of address.

CLAIMANT NAME: THE VEJO RELEGADO MINE / Ueen
 ADDRESS: 56389 East Simmons Way
 CITY: Kearny STATE: AZ ZIP: 85237
 PHONE: 520-363-5692
 SIGNATURE: Ronald Ueen

Claimant or agent must sign to record with the County.

(5)

No of Claims: _____ x \$125 = _____
 Check No: _____ Init: _____
 Receipt No: _____

FOR BLM USE ONLY

United States Department of the Interior
Bureau of Land Management
 BUSINESS & SUPPORT SVCS DIV
 ONE N CENTRAL AVE SUITE 800
 PHOENIX, AZ 85004 -4427
 Phone: (602) 417-9200

Receipt

No:

1751454

Transaction #: 1808722		ENTERED INTO COMPUTER
Date of Transaction: 07/31/2008		
CUSTOMER:	RONALD R DEEN 56389 E SIMMONS WAY KEARNY, AZ 85287	AUG 07 2008 <i>PB</i> & <i>VERIFIED</i>

LINE #	QTY	DESCRIPTION	REMARKS	UNIT PRICE	TOTAL
1	1.00	LOCATABLE MINERALS / MINING CLAIMS-NOT NEW-UNADJUD, ONE AUTH NO. ONLY / MINING CLAIM MONEY RECEIVED (455) CASES: AMC348183/\$2375.00	MAINT 2009	- n/a -	2375.00
TOTAL:					\$2,375.00

PAYMENT INFORMATION					
1	AMOUNT:	\$2,375.00	POSTMARKED:	7/29/08 0:00	
	TYPE:	CHECK	RECEIVED:	07/31/2008	
	CHECK NO:	1297			
	NAME:	SILVER KING MINING COMPANY OF ARIZONA LLC 56389 E SIMMONS WAY KEARNY AZ 85287			

REMARKS

This receipt was generated by the automated BLM Collections and Billing System and is a paper representation of a portion of the official electronic record contained therein.

Lead

348183	-	[348183]
348186 -188		"
348984 -985		[348984]
358030 -031		[358030]
361426 -428		[361425]
372553 -555		[372553]
361425		361425
376993 -996		[376993]

AMC 361425
 AMC 372553
 AMC 376993
 AMC 348183
 AMC 348984
 AMC 358030
 AMC 372553
 AMC 361425
 AMC 376993

MAINTENANCE FEE PAYMENT

Claimant Name: Deen
 Address: 56389 East Simmons Way
 City: Kearny State: AZ Zip: 85237
 Telephone: 520-363-5692
 E-mail address: _____
 Signature: [Signature] for Deen

RECEIVED
 BLM, AZ STATE OFFICE
 2007 AUG 29 P 2: 29
 PHOENIX, ARIZONA
 BLM Date Stamp

Check here if this is a change of address.

LINE NO.	AMC NUMBER	CLAIM/SITE NAME	COUNTY RECORDER DATA (If available)	TWP	RNG	SEC
1	361425	RIPSEY HILL No. 1, 1994	04/06/04	5S	13	12/7
2	372554	RIPSEY HILL No. 2, 1997	06/26/06	5S	13	12
3	376995	RIPSEY HILL No. 3, 1997	01/12/07	5S	13	12
4	376996	RIPSEY HILL No. 4, 1997	01/12/07	5S	13	12
5	372555	RIPSEY HILL No. 7, 1997	06/26/06	5S	13	12, 7, 18
6						
7						
8						
9						
10						

List additional claims on Form MCF114.

Bureau of Land Management
 Arizona State Office
www.az.blm.gov

No. of Claims: 5 x \$125 = 625.00
 Check No: 1156 Init. SC
 Receipt No.: 1556788
 For BLM Use Only

Form: MCF112
 Revised July 2005

This form is available from the Arizona Department of Mines and Mineral Resources and may be reproduced.

52 8/21/07

5/SC

MAINTENANCE FEE PAYMENT

Claimant Name: Deen
 Address: 56389 East Simmons Way
 City: Kearny State: AZ Zip: 85237
 Telephone: 520-363-5692
 E-mail address: _____
 Signature: Ronald Deen

Check here if this is a change of address.

RECEIVED
 BLM, AZ STATE OFFICE
 2007 AUG 29 P 2: 29
 PHOENIX, ARIZONA
 BLM
 Date
 Stamp

LINE NO.	AMC NUMBER	CLAIM/SITE NAME	COUNTY RECORDER DATA (If available)	TWP	RNG	SEC
1			10/06/97			
2	348186	SILVER KING 1997 #1	10/06/97	1S	12E	24
3	348187	SILVER KING 1997 #2	10/06/97	1S	12E	24
4	348188	SILVER KING 1997 #3	10/06/97	1S	12E	24
5	348984	SILVER KING SOUTH	12/22/97	1S	12E	24
6	348985	SILVER KING SW	12/22/97	1S	12E	24
7	358030	SILVER KING 1997	06/18/03	1S	12E	24
8	358031	SILVER KING 1997 #2	06/18/03	1S	12E	24
9	361426	SILVER KING 1997 #8	04/06/04	1S	12E	24
10	361427	SILVER KING 1997 #9	04/06/04	1S	12E	24

List additional claims on Form MCF114.

No. of Claims: 9 x \$125 = 1,125.00
 Check No: 1156 Init. SC
 Receipt No.: 1556788
 For BLM Use Only

Bureau of Land Management
 Arizona State Office
www.az.blm.gov

Form: MCF112
 Revised July 2005

This form is available from the Arizona Department of Mines and Mineral Resources and may be reproduced.

Handwritten initials/signature

MAINTENANCE FEE PAYMENT

Claimant Name: Deen
 Address: 56389 East Simmons Way
 City: Kearny State: AZ Zip: 85237
 Telephone: 520-363-5692
 E-mail address: _____
 Signature: [Handwritten Signature] For Deen

Check here if this is a change of address.

RECEIVED
 BLM ARIZONA STATE OFFICE
 2001 AUG 29 P 2: 29
 PHOENIX, ARIZONA
 BLM
 Date
 Stamp

LINE NO.	AMC NUMBER	CLAIM/SITE NAME	COUNTY RECORDER DATA (If available)	TWP	RNG	SEC
1	372553	Juan (1982)	06/26/06	35	13	7
2	361428	Galena 1992	04/06/04	38	13	7
3						
4						
5						
6						
7						
8						
9						
10						

List additional claims on Form MCF114.

Bureau of Land Management
 Arizona State Office
www.az.blm.gov

No. of Claims: 2 x \$125 = 250.00
 Check No: 1156 Init. SC
 Receipt No.: 1556788
 For BLM Use Only

Form: MCF112
 Revised July 2005

This form is available from the Arizona Department of Mines and Mineral Resources and may be reproduced.

[Handwritten initials]

MAINTENANCE FEE PAYMENT

Claimant Name: Deen
 Address: 56389 East Simmons Way
 City: Kearny State: AZ Zip: 85237
 Telephone: 520-363-5692
 E-mail address: _____
 Signature: [Handwritten Signature]

Check here if this is a change of address.

BLM
Date
Stamp

RECEIVED
BLM, AZ STATE OFFICE
2007 AUG 29 P 2:20
PHOENIX, ARIZONA

LINE NO.	AMC NUMBER	CLAIM/SITE NAME	COUNTY RECORDER DATA (If available)	TWP	RNG	SEC
1	376993	Black Eagle 2006 Lode	10/04/06 1433 01/12/07 1551	14S	12E	14E
2	376994	Crescent 2006 Lode	10/04/06 1433 01/12/07 1551	14S	12E	12E
3						
4						
5						
6						
7						
8						
9						
10						

List additional claims on Form MCF114.

Bureau of Land Management
 Arizona State Office
www.az.blm.gov

No. of Claims: 2 x \$125 = 250.00
 Check No: 1156 Init. SC
 Receipt No.: 1556788
 For BLM Use Only

Form: MCF112
 Revised July 2005

This form is available from the Arizona Department of Mines and Mineral Resources and may be reproduced.

2/SC

United States Department of the Interior

Bureau of Land Management
 BUSINESS & SUPPORT SVCS DIV
 ONE N CENTRAL AVE SUITE 800
 PHOENIX, AZ 85004 -4427
 Phone: (602) 417-9200

Receipt

No: 1556788

Transaction #: 1608409	
Date of Transaction: 08/29/2007	
CUSTOMER:	RONALD DEEN 56389 E SIMMONS WAY KEARNY, AZ 85237

LINE #	QTY	DESCRIPTION	REMARKS	UNIT PRICE	TOTAL
1	1.00	LOCATABLE MINERALS / MINING CLAIMS-NOT NEW-UNADJUD, ONE AUTH NO. ONLY / MINING CLAIM MONEY RECEIVED (455) CASES: AMC376993/\$2250.00	MAINT 2008 (18)	- n/a -	2250.00
TOTAL:					\$2,250.00

PAYMENT INFORMATION			
1	AMOUNT:	\$2,250.00	POSTMARKED: N/A
	TYPE:	CHECK	RECEIVED: 08/29/2007
	CHECK NO:	1156	
	NAME:	DEEN, RONALD 56389 E SIMMONS WAY KEARNY AZ 85237	

REMARKS

This receipt was generated by the automated BLM Collections and Billing System and is a paper representation of a portion of the official electronic record contained therein.

AMC 348183
 348984
 358030

361425
 372553

MAINTENANCE FEE PAYMENT

BUREAU OF LAND MANAGEMENT
 222 N CENTRAL AVENUE
 PHOENIX, AZ 85004
 602-417-9200
 www.az.blm.gov

Mining Claim Maintenance Fee Payment of \$125 per claim/site is due on or before September 1, 2006, in lieu of assessment work for the upcoming assessment year beginning September 1 of the year noted above.

RECEIVED
 B.L.M. AZ STATE OFFICE
 2006 AUG 30 P 12:00
 PHOENIX, ARIZONA
 BLM Date Stamp

AMC NUMBER	CLAIM/SITE NAME	COUNTY RECORDER DATA	SEC	TWP	RNG
348183	EL MEDICO 2052				
348186	SILVER KING 1997 #1				
348187	SILVER KING 1997 #2				
348188	SILVER KING 1997 #3				
348984	SILVER KING SOUTH				
348985	SILVER KING SW				
358030	SILVER KING 1997				
358031	SILVER KING 1997 #4				
361426	SILVER KING 1997 #8				
361427	SILVER KING 1997 #9				

* additional claims on the reverse side of this form.
 Check here if this is a change of address.

AIMANT NAME: THE SILVER KING MINE/Deen
 ADDRESS: 56389 E. Simmons Way
 CITY: Heary STATE: AZ ZIP: 85237
 PHONE: 520-363-5892
 SIGNATURE: [Signature]
 Claimant or agent must sign to record with the County.

No of Claims: 10 x \$125 = 1,250.00
 Check No: CC Init: SC
 Receipt No: 1348024
 FOR BLM USE ONLY

MAINTENANCE FEE PAYMENT

BUREAU OF LAND MANAGEMENT
222 N CENTRAL AVENUE
PHOENIX, AZ 85004
602-417-9200
www.az.blm.gov

Mining Claim Maintenance Fee Payment of \$125 per claim/site is due on or before September 1, 20____, in lieu of assessment work for the upcoming assessment year beginning September 1 of the year noted above.

RECEIVED
BLM, AZ STATE OFFICE
2006 AUG 30 P 12:00
PHOENIX, ARIZONA
BLM Date Stamp

AMC NUMBER	CLAIM/SITE NAME	COUNTY RECORDER DATA	SEC	TWP	RNG
372553	Juan (1982)				
361428	Galena No. 1 1992				

Additional claims on the reverse side of this form.
Check here if this is a change of address.

CLAIMANT NAME: THE W. H. H. MINE / Ronald Deen
ADDRESS: 56389 E. Simmons Way
CITY: Kearny STATE: AZ ZIP: 85237
PHONE: 520-363-5697
SIGNATURE: Ronald Deen

No of Claims: 2 x \$125 = 250.00
Check No: CC Init: SC
Receipt No: 1348024
FOR BLM USE ONLY

Claimant or agent must sign to record with the County.

MAINTENANCE FEE PAYMENT

BUREAU OF LAND MANAGEMENT
222 N CENTRAL AVENUE
PHOENIX, AZ 85004
602-417-9200
www.az.blm.gov

Mining Claim Maintenance Fee Payment of \$125 per claim/site is due on or before September 1, 20____. In lieu of assessment work for the upcoming assessment year beginning September 1 of the year noted above.

RECEIVED
BLM, AZ STATE OFFICE
2006 AUG 30 P 12:00
PHOENIX, ARIZONA
BLM Date Stamp

AMC NUMBER	CLAIM/SITE NAME	COUNTY RECORDER DATA	SEC	TWP	RNG
361425	RIPSEY HILL No. 1, 1994				
372554	RIPSEY HILL No. 2, 1997				
372555	RIPSEY HILL No. 7, 1997				

additional claims on the reverse side of this form.
Check here if this is a change of address.

CLAIMANT NAME: THE RIPSEY HILL MINE/Deer
ADDRESS: 56389 E. Simmons Way
City: Kearny STATE: AZ ZIP: 85287
PHONE: 520-363-5692
SIGNATURE: Ronald Dean
Claimant or agent must sign to record with the County.

No of Claims: 3 x \$125 = 375.00
Check No: CC Init: SC
Receipt No: 1348024
FOR BLM USE ONLY
M. Hyde

United States Department of the Interior
Bureau of Land Management
 BUSINESS & SUPPORT SVCS DIV
 ONE N CENTRAL AVE
 PHOENIX, AZ 85004 -2203
 Phone: (602) 417-9200

Receipt

No: 1348024

Transaction #: 1393301	
Date of Transaction: 08/30/2006	
CUSTOMER:	SILVER KING MINE 56389 E SIMMONS WAY KEARNY, AZ 85237

LINE #	QTY	DESCRIPTION	REMARKS	UNIT PRICE	TOTAL
1	1.00	LOCATABLE MINERALS / MINING CLAIMS-NOT NEW-UNADJUD, ONE AUTH NO. ONLY / MINING CLAIM MONEY RECEIVED (455) CASES: AMC348183/\$1875.00	MAINT 2007 (15)	- n/a -	1875.00
TOTAL:					\$1,875.00

PAYMENT INFORMATION			
NOTE: Items will appear on credit card statement as "Bureau of Land Management".			
1	AMOUNT:	\$1,875.00	POSTMARKED: N/A
	TYPE:	CREDIT CARD	RECEIVED: 08/30/2006
	NAME:	SILVER KING MINE 56389 E SIMMONS WAY KEARNY AZ 85237	
	CARD NO:	XXXXXXXXXXXX7244	AUTH CODE: 030718
	NAME ON CARD:	SILVER KING MINE/ DEEN	
	EXPIRES:	11/30/2007	
	SIGNATURE:		

REMARKS	

This receipt was generated by the automated BLM Collections and Billing System and is a paper representation of a portion of the official electronic record contained therein.

Authorized Date 11/04/2005

Instructions to Accounts AZ BLM REFUND \$250 FOR 2006 MAINTENANCE FEE PAID ON CLOSED
MINING CLAIMS AMC348184 - 348185 RECEIPT #1127311 AB

Login ID 2393

Entry Date 11/04/2005

Total Amount \$250.00

Silver King mining Co of AZ

November 14, 2005

Silver King Mining Co of AZ,

BLM received your maintenance fee payment for 14 mining claims. Two of these claims, AMC348184 and AMC348185 are closed. Therefore, we cannot accept the maintenance fee payment. A refund for \$250 has been authorized. Please allow four to six weeks to receive your refund.

If you have any questions, please contact me at 602-417-9334.

A handwritten signature in cursive script that reads "Amy Bunda".

Amy Bunda
Land Law Examiner

LEAD FILE NUMBERS AMC 348183

348984

358030

361425

AMC NUMBER (S)	#	AMOUNT	LEAD FILE NUMBER
348183 - 348188	6	750	348183
358030 - 358031	2	250	358030
348984 - 348985	2	250	348984
361425 - 361428	4	500	361425
348184 - 348185 ARE BOTH CLOSED (The (582) code couldn't be entered)			
Refunded 11/4/05 AR			
GRAND TOTAL:			14 \$ 1,750
			ENTERED INTO COMPUTER AUG 18 2005 PB

AMC 348183
 348984
 358030
 361425

MAINTENANCE FEE PAYMENT

BUREAU OF LAND MANAGEMENT
 222 N CENTRAL AVENUE
 PHOENIX, AZ 85004
 602-417-9200
 www.az.blm.gov

Mining Claim Maintenance Fee Payment of \$125 per claim/site is due on or before September 1, 20____, in lieu of assessment work for the upcoming assessment year beginning September 1 of the year noted above.

RECEIVED
 B.L.M. AZ STATE OFFICE
 2005 AUG 12 P
 PHOENIX, ARIZONA
 BLM Date Stamp

AMC NUMBER	CLAIM/SITE NAME	COUNTY RECORDER DATA	SECTION	TWP	RANG
348185	Juan				
361428	Galena No.1 1992				

ENTERED INTO COMPUTER
 AUG 18 2005 *ps*

List additional claims on the reverse side of this form.
 Check here if this is a change of address.

CLAIMANT NAME: The H.H.H. Mine / Deen
 ADDRESS: 56389 E-Simmons Way
 CITY: Kearny STATE: AZ ZIP: 85237
 PHONE: 520-363-5692
 SIGNATURE: Donald Deen

No of Claims: 2 x \$125 = 250
 Check No: _____ Init.: TES
 Receipt No: _____
FOR BLM USE ONLY

Claimant or agent must sign to record with the County.

MAINTENANCE FEE PAYMENT

BUREAU OF LAND MANAGEMENT
 222 N CENTRAL AVENUE
 PHOENIX, AZ 85004
 602-417-9200
 www.az.blm.gov

Mining Claim Maintenance Fee Payment of \$125 per claim/site is due on or before September 1, 20____, in lieu of assessment work for the upcoming assessment year beginning September 1 of the year noted above.

RECEIVED
 B.L.M. AZ STATE OFFICE
 2005 AUG 12 P 12: 17
 PHOENIX, ARIZONA
 BLM Date Stamp

AMC NUMBER	CLAIM/SITE NAME	COUNTY RECORDER DATA	SEC	TWP	RNG
361425	RIPSEY HILL No. 1 1994				
348184	RIPSEY HILL No. 2				

ENTERED INTO COMPUTER
 AUG 18 2005 PDS

List additional claims on the reverse side of this form.
 Check here if this is a change of address.

CLAIMANT NAME: The RIPSEY HILL MINE / Deen
 ADDRESS: 58389 E Simmons Way
 CITY: Hearny STATE: AZ ZIP: 85237
 PHONE: 520-263-5692
 SIGNATURE: Ronald Deen

No of Claims: 2 x \$125 = 250.⁰⁰
 Check No: _____ Init: TD
 Receipt No: _____
FOR BLM USE ONLY

Claimant or agent must sign to record with the County.

MAINTENANCE FEE PAYMENT

BUREAU OF LAND MANAGEMENT
 222 N CENTRAL AVENUE
 PHOENIX, AZ 85004
 602-417-9200
 www.az.blm.gov

Mining Claim Maintenance Fee Payment of \$125 per claim/site is due on or before September 1, 20____, in lieu of assessment work for the upcoming assessment year beginning September 1 of the year noted above.

RECEIVED
 B.L.M. AZ STATE OFFICE
 2005 AUG 12 12:12
 PHOENIX, ARIZONA
 BLM Date stamp

AMC NUMBER	CLAIM/SITE NAME	COUNTY RECORDER DATA	SEC	TWP	RNG
348183	EL MEDICO 2052				
348186	SILVER KING 1997*1				
348187	SILVER KING 1997*2				
348188	SILVER KING 1997*3				
348984	SILVER KING SOUTH				
348985	SILVER KING SW				
358030	SILVER KING 1997				
358031	SILVER KING 1997*4				
361426	SILVER KING 1997*8				
361427	SILVER KING 1997*9				

ENTERED INTO COMPUTER
 AUG 18 2005 PB

List additional claims on the reverse side of this form.
 Check here if this is a change of address.

CLAIMANT NAME: The SILVER KING MINE / Deen
 ADDRESS: 56389 E. Simmons Way
 CITY: Kearny STATE: AZ ZIP: 85237
 PHONE: 520-363-5692
 SIGNATURE: [Signature]

No of Claims: 10 x \$125 = 1250
 Check No: _____ Init: [Signature]
 Receipt No: _____
FOR BLM USE ONLY

Claimant or agent must sign to record with the County.

LEAD FILE NUMBERS AMC 348183

348984

358030

361425

AMC NUMBER (S)	#	AMOUNT	LEAD FILE NUMBER
348183 - 348188	6	750	348183
358030 - 358031	2	250	358030
348984 - 348985	2	250	348984
361425 - 361428	4	500	361425
348184 - 348185 ARE BOTH CLOSED (The (582) code couldn't be entered)			
GRAND TOTAL:			14 \$ 1,750

ENTERED INTO COMPUTER
AUG 18 2005 PB

AMC 348183
 348984
 358030
 361425

MAINTENANCE FEE PAYMENT

BUREAU OF LAND MANAGEMENT
 222 N CENTRAL AVENUE
 PHOENIX, AZ 85004
 602-417-9200
 www.az.blm.gov

Mining Claim Maintenance Fee Payment of \$125 per claim/site is due on or before September 1, 20____, in lieu of assessment work for the upcoming assessment year beginning September 1 of the year noted above.

RECEIVED
 B.L.M. AZ STATE OFFICE
 2005 AUG 12 PD
 PHOENIX, ARIZONA
 BLM Date Stamp

AMC NUMBER	CLAIM/SITE NAME	COUNTY RECORDER DATA	SECTION	TWP	RNG
348185	Juan				
361428	Galena No. 1 1992				

ENTERED INTO COMPUTER
 AUG 18 2005 RB

List additional claims on the reverse side of this form.
 Check here if this is a change of address.

CLAIMANT NAME: The H.H.H. Mine / Deen
 ADDRESS: 56389 E - Simmons Way
 CITY: Kearny STATE: AZ ZIP: 85237
 PHONE: 520-363-5692
 SIGNATURE: Donald Deen

No of Claims: 2 x \$125 = 250
 Check No: _____ Init: TES
 Receipt No: _____
FOR BLM USE ONLY

Claimant or agent must sign to record with the County.

MAINTENANCE FEE PAYMENT

BUREAU OF LAND MANAGEMENT
 222 N CENTRAL AVENUE
 PHOENIX, AZ 85004
 602-417-9200
 www.az.blm.gov

Mining Claim Maintenance Fee Payment of \$125 per claim/site is due on or before September 1, 20____, in lieu of assessment work for the upcoming assessment year beginning September 1 of the year noted above.

RECEIVED
 B.L.M. AZ STATE OFFICE
 2005 AUG 12 P 12:17
 PHOENIX, ARIZONA
 BLM Date Stamp

AMC NUMBER	CLAIM/SITE NAME	COUNTY RECORDER DATA	SEC	TWP	RNG
361425	RIPSEY HILL No. 1 1994				
348184	RIPSEY HILL No. 2				

ENTERED INTO COMPUTER
 AUG 18 2005 (15)

List additional claims on the reverse side of this form.
 Check here if this is a change of address.

CLAIMANT NAME: The RIPSEY HILL MINE / Deen
 ADDRESS: 58389 E Simmons Way
 CITY: Kearny STATE: AZ ZIP: 85237
 PHONE: 520-363-5692
 SIGNATURE: Donald Deen

No of Claims: 2 x \$125 = 250.⁰⁰
 Check No: _____ Init: TD
 Receipt No: _____
FOR BLM USE ONLY

Claimant or agent must sign to record with the County.

MAINTENANCE FEE PAYMENT

BUREAU OF LAND MANAGEMENT
 222 N CENTRAL AVENUE
 PHOENIX, AZ 85004
 602-417-9200
 www.az.blm.gov

Mining Claim Maintenance Fee Payment of \$125 per claim/site is due on or before September 1, 20____, in lieu of assessment work for the upcoming assessment year beginning September 1 of the year noted above.

RECEIVED
 B.L.M. AZ STATE OFFICE
 2005 AUG 12 P 2:17
 PHOENIX, ARIZONA
 BLM Date Stamp

AMC NUMBER	CLAIM/SITE NAME	COUNTY RECORDER DATA	SEC	TWP	RNG
348183	EL MEDICO 2052				
348186	SILVER KING 1997#1				
348187	SILVER KING 1997#2				
348188	SILVER KING 1997#3				
348984	SILVER KING SOUTH				
348985	SILVER KING SW				
358030	SILVER KING 1997				
358031	SILVER KING 1997#4				
361426	SILVER KING 1997#8				
361427	SILVER KING 1997#9				

ENTERED INTO COMPUTER

AUG 18 2005 PB

List additional claims on the reverse side of this form.

Check here if this is a change of address.

CLAIMANT NAME: The SILVER KING MINE / Dean
 ADDRESS: 56389 E. Simmons Way
 CITY: Kearny STATE: AZ ZIP: 85237
 PHONE: 520-363-5692
 SIGNATURE: [Signature]

Claimant or agent must sign to record with the County.

No of Claims: 10 x \$125 = 1250
 Check No: _____ Init: [Signature]
 Receipt No: _____
FOR BLM USE ONLY

**United States Department of the Interior
Bureau of Land Management**

BUSINESS & SUPPORT SVCS DIV
222 N CENTRAL AVE
PHOENIX, AZ 85004 -2203
Phone: (602) 417-9200

Receipt	
No:	1127311

Transaction #: 1166316
Date of Transaction: 08/12/2005

ENTERED INTO COMPUTER
AUG 18 2005 *FB*

CUSTOMER:	SILVER KING MINING CO OF AZ 56389 E SIMMONS WAY KEARNY, AZ 85237
------------------	--

LINE #	QTY	DESCRIPTION	REMARKS	UNIT PRICE	TOTAL
1	1.00	LOCATABLE MINERALS / MINING CLAIMS-NOT NEW-UNADJUD, ONE AUTH NO. ONLY / MINING CLAIM MONEY RECEIVED (455) CASES: AMC361425/\$1750.00	MAINT 2006 - 14	- n/a -	1750.00
TOTAL:					\$1,750.00

PAYMENT INFORMATION			
1	AMOUNT:	\$1,750.00	POSTMARKED: N/A
	TYPE:	CHECK	RECEIVED: 08/12/2005
	CHECK NO:	1292	
	NAME:	SILVER KING MINING CO OF AZ 56389 E SIMMONS WAY KEARNY AZ 85237	

REMARKS

This receipt was generated by the automated BLM Collections and Billing System and is a paper representation of a portion of the official electronic record contained therein.

Sept. 1, 2003

60

UNITED STATES
DEPARTMENT OF THE INTERIOR
BUREAU OF LAND MANAGEMENT
MAINTENANCE FEE WAIVER CERTIFICATION

FORM APPROVED
OMB NO. 1004-0114
Expires: December 31, 2002

SEE INSTRUCTIONS ON REVERSE

AMC 358030

1. This small miner waiver is filed for the assessment year beginning at noon on September 1, 2003 and ending at noon on September 1, 2004.
2. The undersigned and all related parties owned ten or fewer mining claims, mill, or tunnel sites located and maintained on Federal lands in the United States of America on September 1, 2003.
3. The undersigned have performed the assessment work **required by law** for each mining claim listed **prior to filing this waiver** and understand that by filing this form; an affidavit of assessment work **must** be recorded by the December 30th following the filing of this waiver.
4. The undersigned understand that if the assessment work obligation has not yet come due under 30 U.S.C. 28 (for those claims in their first assessment year only); a notice of intent to hold reciting this condition **must** be recorded by the December 30th following the filing of this waiver.
5. The undersigned understand that mill and tunnel sites may also be listed upon this waiver and be waived from payment of the maintenance fee; and that a notice of intent to hold for these sites is required to be recorded by the December 30th immediately following the filing of this waiver.
6. The undersigned understand and acknowledge that pursuant to 43 U.S.C. 1212 and 18 U.S.C. 1001; the filing or recording of a false, fictitious, or fraudulent document with the Bureau of Land Management may result in a fine of up to \$250,000, a prison term not to exceed five years, or both.
7. The mining claims, mill or tunnel sites for which this waiver from payment of the maintenance fees is requested are:

CLAIM OR SITE NAME	BLM RECORDATION SERIAL NUMBER
1. Silver King 1997	AMC 358030
2. Silver King 1997 #4	AMC 358031
3.	
4.	
5.	
6.	
7.	
8.	
9.	
10.	

The owner(s) (claimants) of the above mining claims and sites are:

Ronald R. Deen

(Owner's Name - Please Print)

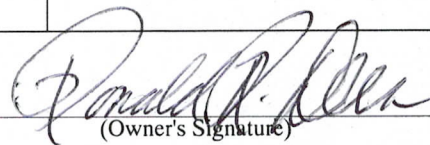

(Owner's Signature)

56389 E. Simmons Wy

(Street or P.O. Box)

Kenau

(City)

AZ

(State)

85237

(Zip Code)

(Owner's Name - Please Print)

(Owner's Signature)

(Street or P.O. Box)

(City)

(State)

(Zip Code)

(Owner's Name - Please Print)

(Owner's Signature)

(Street or P.O. Box)

(City)

(State)

(Zip Code)

ENTERED IN COMPUTER

6/27/03 *mtt*

(Owner's Name - Please Print)	(Owner's Signature)
(Street or P.O. Box)	(City) (State) (Zip Code)
(Owner's Name - Please Print)	(Owner's Signature)
(Street or P.O. Box)	(City) (State) (Zip Code)
(Owner's Name - Please Print)	(Owner's Signature)
(Street or P.O. Box)	(City) (State) (Zip Code)
(Owner's Name - Please Print)	(Owner's Signature)
(Street or P.O. Box)	(City) (State) (Zip Code)

INSTRUCTIONS

- | | |
|--|---|
| <ol style="list-style-type: none"> 1. This certification is made under the provisions of § 1744 of Title 43 and § 28-28k of Title 30 of the United States Code; and the regulations thereunder (43 CFR Part 3830). 2. The claimant(s) must fill in the dates in paragraph 1 for the beginning and ending of the assessment year for which this waiver is sought. 3. The claimant(s) must fill in the date in paragraph 2 for the beginning of the assessment year for which this waiver is sought. 4. All claim and site names and Bureau of Land Management (BLM) serial numbers must be listed for the mining claims, mill sites, and tunnel sites for which the waiver is sought. 5. All owners of the mining claims, mill sites, and tunnel sites and their addresses must be given. 6. This waiver form must be signed by all the claimants or their designated agent, in original form. If an agent is designated, a notarized designation of agent, signed by all of the claimants with proper address given, must be submitted with this waiver. | <ol style="list-style-type: none"> 7. This form must be filed no later than September 1st for the upcoming assessment year in the BLM State Office where the mining claims or sites are recorded, or the waiver cannot be granted by the BLM. (Example: to obtain a waiver for the assessment year 2000, which begins at noon on September 1, 1999, you must qualify for and file for a waiver no later than September 1, 1999 in the proper BLM State Office). 8. For all mining claims which require assessment work, you must record an affidavit of labor on or before the December 30th immediately following the filing of this waiver. For all other mining claims or sites waived, you must record a notice of intent to hold on or before the December 30th immediately following the filing of this waiver. 9. Mill and tunnel sites may also be listed upon this waiver and be waived from payment of the maintenance fee. A notice of intent to hold for these sites is required to be filed by the December 30th following the filing of this waiver. |
|--|---|

NOTICE/BURDEN HOURS STATEMENT

The Privacy Act of 1974, *as amended*, and the regulation in 43 CFR 2.48(d) provide that you be furnished the following information in connection with the information required by this certification of waiver from rental fees.

AUTHORITY: 30 U.S.C. 28-28k; 43 U.S.C. 1201, 1457, 1740, and 1744; and 43 CFR 3830.

PRINCIPLE PURPOSE: This information is to be used to verify that the owner(s) (claimants) of a mining claim has complied with 30 U.S.C. 28f and is entitled to perform assessment work in lieu of paying the maintenance fee for the mining claims listed on this form.

ROUTINE USE: (1) Adjudication of the claimant(s) certification of waiver from paying the maintenance fee otherwise required by 30 U.S.C. 28f. (2) Disclosure may be made to appropriate Federal agencies when location is made within the agency's geographic area of responsibility. (3) Information from the record and/or the record will be transferred to the appropriate Federal, State, or local agency, or a member of the public in response to a specific request for pertinent information. (4) Information may also be provided to the Department of Justice or in a proceeding before a court or adjudicative body; or to Federal, State, local or foreign agencies when needed for enforcement of civil or criminal codes or applicable regulations concerning title rights upon the public land.

EFFECT OF NOT PROVIDING INFORMATION: Disclosure of this information is required by 30 U.S.C. 28f and 43 CFR Part 3830 for those qualified claimants wishing to take the small miner waiver allowed. Failure to supply the information required in this form to support the claimants certification of waiver from payment of the otherwise required maintenance fees will result in the waiver being disallowed and the mining claims subject to forfeiture by BLM under 30 U.S.C. 28i.

The Paperwork Reduction Act of 1995 requires us to inform you that:

This information is being collected to allow the BLM to determine if you qualify for a waiver from the payment of \$100 per mining claim or site maintenance fee established in 30 U.S.C. 28f and the implementing regulations at 43 CFR 3830. A response to this request is required in accordance with the statute to obtain your benefit.

BLM would like you to know that you do not have to respond to this, or any other, Federal agency-sponsored information collection unless it displays a currently valid OMB control number.

Public reporting burden for this form is estimated to average 8 minutes (0.133 hours) per response, including time to review instructions, gathering and maintaining data, and completing and reviewing the form. Direct comments regarding this burden estimate, or any other aspect of this form, to the U.S. Department of the Interior, Bureau of Land Management, (1004-0114) Bureau Clearance Officer (WO-630), Mail Stop 401 LS, 1849 C St., N.W., Washington, D.C. 20240.

PHOENIX, ARIZONA

FOR OFFICIAL USE ONLY
09 JUN 11 11:11 AM '00

RECEIVED
BLM, AZ STATE OFFICE

AMC 348183
AMC 358030
AMC 348984

Return Document to: _____ A3850-1(NOV.2001)

Telephone: _____

No. of Claims: _____ x \$5 = _____
Receipt No.: _____ Check No.: _____
Init: _____
FOR BLM USE ONLY

- AFFIDAVIT OF PERFORMANCE OF ANNUAL WORK.** Also fill in Items 1 through 9 and the reverse side of this document.
- NOTICE OF INTENTION TO HOLD.** I intend to hold the claim(s)/site(s) listed on the reverse side of this document for the calendar year 2003. Also fill in Items 1 through 4 and Item 9.

Notices of Intention to Hold are for mill sites and tunnel sites or for mining claims when assessment work has not been done, regardless of whether the annual assessment has been suspended, deferred, or not yet accrued. The filing of a Notice of Intention to Hold shall not relieve the owner of complying with federal and state laws pertaining to the performance of annual assessment work. Notices of Intention to Hold for mill sites or tunnel sites need not be county recorded. For mining claims the form filed with the Bureau of Land Management (BLM) must be identical to the one that was or will be filed with the county.

Evidence of Annual Assessment Work or a Notice of Intention to Hold must be filed each calendar year following the calendar year in which the claim/site was located. **All claims listed on a single affidavit must be contiguous.**

- 1. State of Arizona, County of Pinal ss:
- 2. I, (Name) Ronald R. Deen
- 3. Reside at (Address) 56389 East
City Kearny, County Pinal, State AZ Zip 85237

being duly sworn, deposes and says that he/she is a citizen of the United States, more than eighteen years of age, that all of the facts set forth in this affidavit/notice, subject to the provisions and penalties of 18 U.S.C. 1001 pertaining to the filing of false, fictitious, or fraudulent statements with the United States, are true and correct according to the best of my knowledge, information and belief.

- 4. Owner's name and address (If not shown in Items 1-3 above). Check here if this is a change of address.
Ronald R. Deen, 56389 East Simmons Wy, Kearny, AZ 85237

- 5. That I am personally acquainted with the mining claim(s). The work and improvements were made by and at the expense of the owner(s) of said claim(s). Said contiguous group of claims, listed on the reverse side of this document, are situated in the Pioneer Superior Mining District, Pinal County, Arizona.

- 6. That between the dates starting at 12 o'clock noon on September 1, 20____ and ending at 12 o'clock noon on September 1, 20____ at least \$ _____ Dollars worth of work and improvements were done and performed upon said claim(s) or upon one or more of a contiguous group of claims for the benefit of all, or wholly or partly outside of a contiguous group of claims for the benefit of all, not including the location work.

- 7. That the following persons were employed to perform the work and improvements described herein: Ron Deen
Gary Deen

ENTERED
6/27/02 MZ

8. That the work and improvements performed were: General Claim Work

9. Dated: _____ Signature: _____

SUBSCRIBED AND SWORN TO before me, a Notary Public, this _____ day of _____, 20____
by _____
Notary Public _____
MY COMMISSION EXPIRES _____

If the claims/sites have consecutive BLM numbers and are in the same Township, Range and Section(s), they may be listed as follows:

Sample 1 - 10	A MC 19640 - 49	Dkt/Pg 1025/1-10 Recording #9106173-82	TWN		
			4N	20W	36
<u>Claim/Site Name</u>	<u>Serial Number</u>	<u>Dkt/Pg or Record # of Orig Location Notice</u>	<u>SHP</u>	<u>RNG</u>	<u>SEC(S)</u>
<u>Silver King 1997</u>	<u>AMC 358030</u>	_____	_____	_____	_____
<u>Silver King 1997 #4</u>	<u>AMC 358031</u>	_____	_____	_____	_____
_____	_____	_____	_____	_____	_____
_____	_____	_____	_____	_____	_____
_____	_____	_____	_____	_____	_____
_____	_____	_____	_____	_____	_____
_____	_____	_____	_____	_____	_____
_____	_____	_____	_____	_____	_____
_____	_____	_____	_____	_____	_____
_____	_____	_____	_____	_____	_____
_____	_____	_____	_____	_____	_____

BLM requires a \$5 nonrefundable service charge for each mining claim, mill site or tunnel site payable on or before December 30th (not the 31st). Mail to:

Bureau of Land Management
222 North Central Avenue
Phoenix, Arizona 85004-2203
602-417-9200
www.az.blm.gov

This form is for the purpose of complying with the laws of the United States Department of the Interior, Bureau of Land Management and the State of Arizona pertaining to assessment work and/or notice of intention to hold. 30 U.S.C. 28, 43 CFR 3833.2, ARS 27-208. Subject to Paperwork Reduction Act and Privacy Act statements available at the BLM AZ State Office. This form is not copyrighted. It may be reproduced without permission.

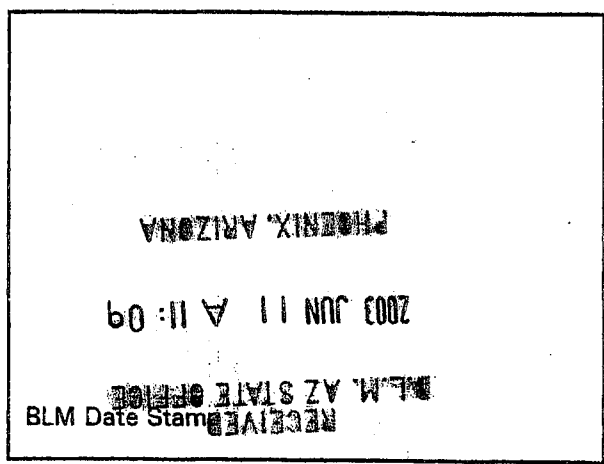

MAINTENANCE FEE PAYMENT

Mining Claim Maintenance Fee Payment of \$100 per claim or site is due on or before September 1, 2003, in lieu of assessment work for the upcoming assessment year beginning September 1 of the year noted above.

BUREAU OF LAND MANAGEMENT
ARIZONA STATE OFFICE
222 NORTH CENTRAL AVENUE
PHOENIX, AZ 85004
602-417-9200
www.az.blm.gov

FOR BLM USE ONLY	
NO. OF CLAIMS: <u>6</u>	X \$100 = \$ <u>600.⁰⁰</u>
RECEIPT NO.: _____	CHECK NO.: _____
INIT: <u>MC</u>	

The claims are situated in Pinal County, Arizona.

BLM SERIAL NUMBERS

NAMES OF CLAIMS OR SITES

AMC _____ THRU AMC _____ NAME: _____
 COUNTY BOOK/DOCKET _____ PAGE OR FEE NO: _____
 AMC _____ THRU AMC _____ NAME: _____
 COUNTY BOOK/DOCKET _____ PAGE OR FEE NO: _____

IF NOT CONSECUTIVE NUMBERS LIST SEPARATELY BELOW

BLM SERIAL NUMBERS	NAME OF CLAIMS/SITES	CO/BOOK DOCKET & PAGE OR FEE NUMBER
AMC <u>348183</u>	<u>EL MEDICO 2052</u>	_____
AMC <u>348186</u>	<u>SILVER KING 1997 #1</u>	_____
AMC <u>348187</u>	<u>SILVER KING 1997 #2</u>	_____
AMC <u>348188</u>	<u>SILVER KING 1997 #3</u>	_____

List additional claims on the reverse side of this form.

CLAIMANT'S NAME: Ronald R. Deen, Joe Deen, Ron Deen + Gary Deen
 ADDRESS: 56389 East Simmons Way CITY: Kearny STATE: AZ ZIP: 85237
 PHONE: 520-363-5692

Check here if this is a change of address

PHOENIX, ARIZONA
2003 JUN 11 A 11:09
RECEIVED BLM AZ STATE OFFICE
BLM DATE STAMP

ENTERED IN COMPUTER

6/27/03 MCN

United States Department of the Interior
Bureau of Land Management
 BUSINESS & SUPPORT SVCS DIV
 222 N CENTRAL AVE
 PHOENIX, AZ 85004 -2203
 Phone: (602) 417-9200

Receipt	
No:	695222

Transaction #: 723877
Date of Transaction: 06/11/2003

CUSTOMER: GARY DEEN
 56389 E SIMMONS WAY
 KEARNY, AZ 85237

LINE #	QTY	DESCRIPTION	REMARKS	UNIT PRICE	TOTAL
1	2.00	LOCATABLE MINERALS / MINING CLAIMS-NEW, UNADJUDI, ONE OR MORE AUTH NO'S / NEW MINING CLAIM LOCATION FEE \$25(1993) CASES: AMC358030/\$25.00, AMC358031/\$25.00		- n/a -	50.00
2	2.00	LOCATABLE MINERALS / MINING CLAIMS-NEW, UNADJUDI, ONE OR MORE AUTH NO'S / NEW MINING CLAIM SVC CHG \$10 (1930) CASES: AMC358030/\$10.00, AMC358031/\$10.00		- n/a -	20.00
3	2.00	LOCATABLE MINERALS / MINING CLAIMS-NEW, UNADJUDI, ONE OR MORE AUTH NO'S / NEW MINING CLM MAINT FEE \$100(1993) CASES: AMC358030/\$100.00, AMC358031/\$100.00	MAIN 2003 (2)	- n/a -	200.00
4	1.00	LOCATABLE MINERALS / MINING CLAIMS-NOT NEW-UNADJUD, ONE AUTH NO. ONLY / MINING CLAIM MONEY RECEIVED (455) CASES: AMC348183/\$600.00	MAIN 2004 (6)	- n/a -	600.00
5	1.00	SUSPENSE, MISCELLANEOUS / SUSPENSE, MISCELLANEOUS / TEMPORARY SUSPENSE, MISC (455)	NOI 2003 (2)	- n/a -	10.00
6	5.00	IAC PRODUCTS / COPIES / CASEFILE/DOCUMENT COPIES / COPIES (B/W UP TO 11X17)-\$.13/P		0.13	0.65

TOTAL:	\$880.65
---------------	-----------------

PAYMENT INFORMATION				
1	AMOUNT:	\$880.65	POSTMARKED:	N/A
	TYPE:	CHECK	RECEIVED:	06/11/2003
	CHECK NO:	1062		
	NAME:	SILVER KING MINING CO 56389 E SIMMONS WAY KEARNY AZ 85237		

REMARKS
THE \$10. FEE IS FOR A NOI FOR AMC 358030 & AMC358031

This receipt was generated by the automated BLM Collections and Billing System and is a paper representation of a portion of the official electronic record contained therein.

NOTICE!!

These documents have been scanned!

Do not place un-scanned documents beneath this notice!

Do not remove this notice from this file!

GPO Jacket No. 560-102
Print Order 61540
Rise Business Services, LLC
Job=AZ15 6/6/2019



Box Number= AZ15122



Claim Begin-End: AMC358030-AMC358031

5 Miscellaneous



AZ15122-6

AMC357873-AMC358493

**NO
DOCUMENTS
FOUND**

NO DOCUMENTS FOUND
NO DOCUMENTS FOUND

NOTICE!!

These documents have been scanned!

Do not place un-scanned documents beneath this notice!

Do not remove this notice from this file!

GPO Jacket No. 560-102
Print Order 61540
Rise Business Services, LLC
Job=AZ15 6/6/2019



Box Number= AZ15122



Claim Begin-End: AMC358030-AMC358031

6 Location Notices-Amendments and Supporting Documents



AZ15122-6 AMC357873-AMC358493

**DEPARTMENT OF THE INTERIOR
BUREAU OF LAND MANAGEMENT**

**MINING CLAIMS
(LIVE) Serial Register Page**

RunDate/Time: 05/24/04 08:26 AM

Page 1 of 2

01 05-10-1872;017STAT0091;30USC26,28,34
Case Type 384101: LODE CLAIM
Claim Name: SILVER KING 1997
Commodity :
Case Disposition: ACTIVE

**Serial Number
AMC358030**

Name & Address	Int Rel	% Interest
DEEN GARY 56389 E SIMMONS WAY KEARNY, AZ 85237	CLAIMANT	0.0000000
DEEN JOE 56389 E SIMMONS WAY KEARNY, AZ 85237	CLAIMANT	0.0000000
DEEN RON 56389 E SIMMONS WAY KEARNY, AZ 85237	CLAIMANT	0.0000000
DEEN RONALD SR 56389 E SIMMONS WAY KEARNY, AZ 85237	CLAIMANT	0.0000000

Mer Twp Rng Sec	Quadrant	District/Resource	County
14 0010S 0120E 024	NW SW	PHOENIX FIELD OFFICE	PINAL

Act Date	Code	Action	Action Remarks	Receipt Number
06/10/2003	403	LOCATION DATE		
06/11/2003	395	RECORDATION NOTICE RECD	\$25.00;1	695222
06/11/2003	483	SMALL MINER CERT FILED	2004	
06/11/2003	481	NOTICE OF INTENT TO HOLD	2003	695222
06/11/2003	484	LOCATION YEAR / MAINTENANCE FEE	2003	695222
05/21/2004	669	LAND STATUS CHECKED		
06/11/2003	501	ACCT ADV IN LEAD FILE	AMC358030;	

Line Nr Remarks

DEPARTMENT OF THE INTERIOR
BUREAU OF LAND MANAGEMENT
MINING CLAIMS
(LIVE) Serial Register Page

RunDate/Time: 05/24/04 08:26 AM

Page 2 of 2

01 05-10-1872;017STAT0091;30USC26,28,34
Case Type 384101: LODE CLAIM
Claim Name: SILVER KING 1997 #4
Commodity :
Case Disposition: ACTIVE

Serial Number
AMC358031

Name & Address				Int Rel	% Interest
DEEN GARY	56389 E SIMMONS WAY	KEARNY, AZ 85237		CLAIMANT	0.0000000
DEEN JOE	56389 E SIMMONS WAY	KEARNY, AZ 85237		CLAIMANT	0.0000000
DEEN RON	56389 E SIMMONS WAY	KEARNY, AZ 85237		CLAIMANT	0.0000000
DEEN RONALD SR	56389 E SIMMONS WAY	KEARNY, AZ 85237		CLAIMANT	0.0000000

Mer Twp	Rng	Sec	Quadrant	District/Resource	County
14	0010S	0120E	024 NE	PHOENIX FIELD OFFICE	PINAL

Act Date	Code	Action	Action Remarks	Receipt Number
06/10/2003	403	LOCATION DATE		
06/11/2003	395	RECORDATION NOTICE RECD	\$25.00;1	695222
06/11/2003	483	SMALL MINER CERT FILED	2004	
06/11/2003	481	NOTICE OF INTENT TO HOLD	2003	695222
06/11/2003	484	LOCATION YEAR / MAINTENANCE FEE	2003	695222
05/21/2004	669	LAND STATUS CHECKED		
06/11/2003	501	ACCT ADV IN LEAD FILE	AMC358030;	

Line Nr Remarks

MINING CLAIM STATUS REPORT

1001758

Status Checked By:	AMC
ITP Checked By:	AMC
GEO Checked By:	AMC
Preadjudication By:	
Final Adjudication By:	WFE

LEAD SERIAL NO AMC 358030 THROUGH AMC 358031 6 maint 600.00

<u>2</u>	LODE	@ \$25 = \$	<u>50.00</u>	Location Fee	2 claims \$270.00
	PLACER	@ \$10 = \$	<u>20.00</u>	Service Fee curable defect	2 NOI's 10.00
	MILL SITE	@ \$100 = \$	<u>200.00</u>	Claim Maintenance Fee	5 1/2 2000 prints .65
	TUNNEL SITE	\$		TOTAL FEES	
	ASSOCIATION	\$		Copy Fees,	
	PLACER	\$		Overage <input type="checkbox"/> Shortage <input type="checkbox"/>	
		\$	<u>270.00</u>	TOTAL RECEIVED	TOTAL \$880.65

OVER THE-COUNTER: MAIL: Timely Filed: YES NO

LEGAL DESCRIPTION:

T <u>15</u>	R <u>12E</u>	S <u>24</u>	T _____	R _____	S _____
T _____	R _____	S _____	T _____	R _____	S _____
T _____	R _____	S _____	T _____	R _____	S _____
T _____	R _____	S _____	T _____	R _____	S _____

GENERAL JURISDICTION: BLM or NATIONAL FOREST _____
Name

SPLIT ESTATE LAND SX PX SRHE OTHER _____
Specify

WILDERNESS AREA (WA): _____
Specify

CLAIMS SUBJECT TO PL 359: YES NO

PROPER NOTICE FILED IF LOCATING ON SRHE: YES NO

COMMENTS: _____

STATUS: PARTIALLY VOID VOID

PRIVATE MINERALS WITHDRAWN OTHER

COMMENTS: _____

Ronald R. Deen
56389 E. Simmons Wy
Kearny, Az-85237

Lode

NOTICE OF LOCATION

NOTICE IS HEREBY GIVEN That the Silver King 1997 Mining Claim was located by Gary T. Deen, Ron R. Deen & F. Joe Deen on this 10th day of June, 2003, for mining purposes. Said claim is 1500 feet in length along the vein or deposit of mineral-bearing rock in place and 300 feet in width on each side of the center of said vein or deposit, from end to end of said claim. The general course of this claim is North to South and is situated in the Pioneer (Superior) Mining District Pinal County, Arizona, about 2 1/2 miles North of Superior, Az. and 10,000± ft. South West King Crown Peak, All in Township 1S, Range 12E Sec 24

(Write on above lines the distance and direction the claim is from some permanent and natural object, such as a mountain, peak, stream, etc.)

This claim runs from the discovery monument, or stake on which the notice is posted, 840± ft feet in a North direction to the North center end monument, or stake, and 860± feet in a South direction from the aforesaid monument, or stake, to the South center end monument

or stake, and is also marked by two corner monuments, or stakes, at each end of said claim, one on each side of and 300 feet from the center end monuments, or stakes, making the claim in the form of a parallelogram.

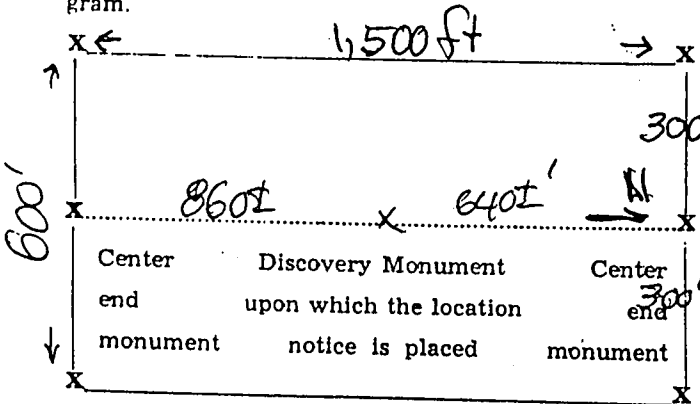

Gary T. Deen
Ron R. Deen
F. Joe Deen
Ronald R. Deen

RECEIVED
P.M. AZ STATE
JUN 11 A 11:03
PHOENIX, ARIZONA

STATE OF ARIZONA, County of PINAL

ss.: Fee No. 2003-040453

I hereby certify that the within instrument was filed and recorded at request of _____ in Docket _____ Page 3 and indexed in _____

Witness my hand and official seal the day and year aforesaid.

County Recorder

By _____

Deputy Recorder.

see map attached

ARJ 558030

ARIZONA STATE OFFICE

RECEIVED
B.L.M.
ARIZONA STATE OFFICE

SEP 3 2 27 PM '97

N

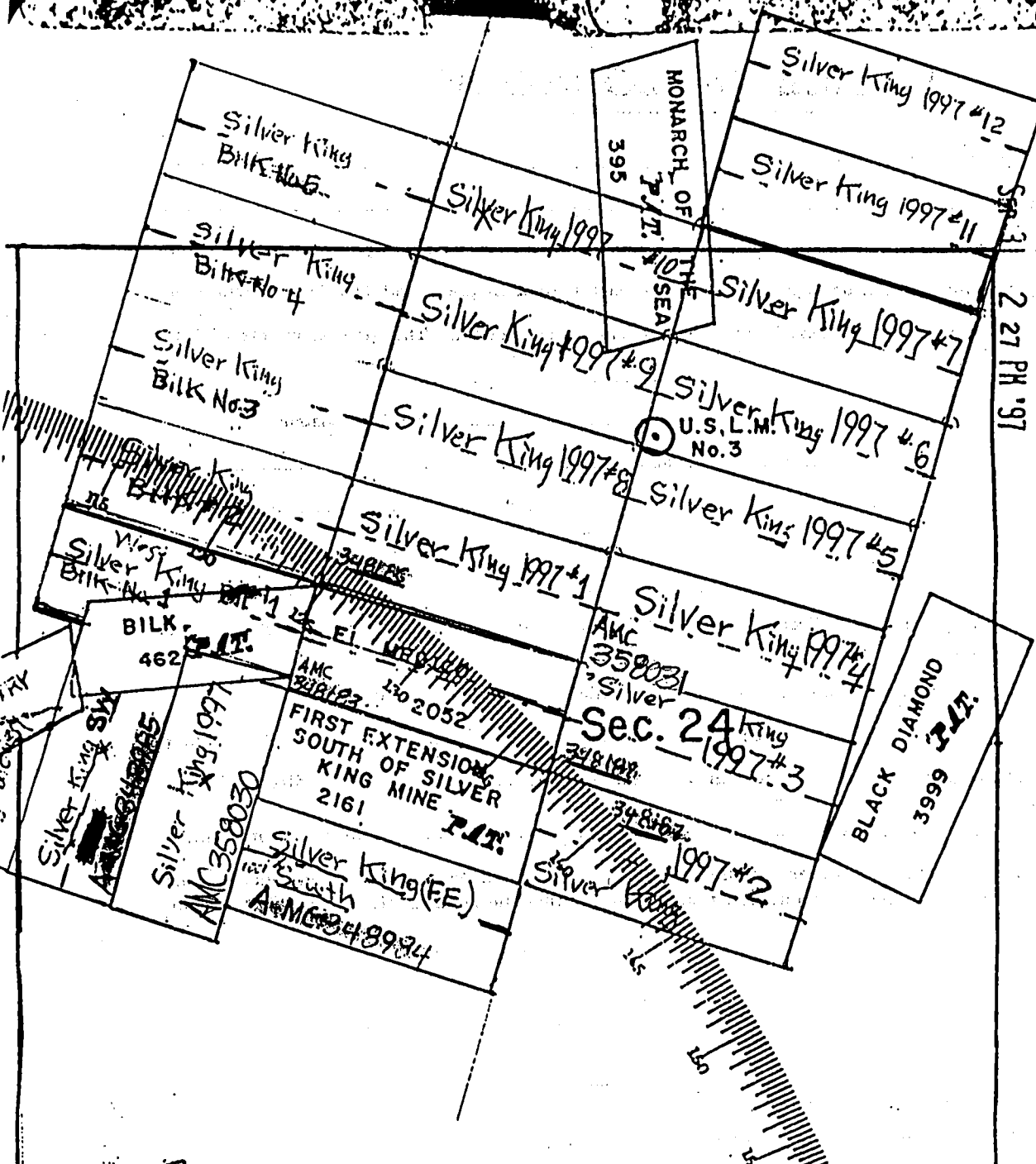

Section 24, Township 1S, Range 12E

Joe Deen / Silver King Mine Map
 Ron Deen
 Gary Deen
 Ronald Deen, Sr.
 56389 E. Simmons Way
 Kearny, AZ 85237

Ronald K. Deen
56389 E. Simmons Wly
Tearny, Az. 85237

Lode NOTICE OF LOCATION

NOTICE IS HEREBY GIVEN That the Silver King 1997 #4 Mining
Claim was located by Joe Deen, Ron Deen + Gary Deen
on this 10th day of June, 2003, for mining purposes. Said claim
is 1500 feet in length along the vein or deposit of mineral-bearing rock in place and 300 feet in width on
each side of the center of said vein or deposit, from end to end of said claim. The general course of this
claim is West to East
and is situated in the Superior Mining District
Pinal County, Arizona, about 3 miles North of
Superior, Az. and 4,000 ft South West King Crown Peak
All in Township 1S, Range 12E Sec 24

(Write on above lines the distance and direction the claim is from some permanent and natural object, such as a mountain, peak, stream, etc.)

This claim runs from the discovery monument, or stake on which the notice is posted, 300
feet in a Westerly direction to the West center
end monument, or stake, and 1,200 feet in a Easterly
direction from the aforesaid monument, or stake, to the East center end monument

or stake, and is also marked by two corner monuments, or stakes, at each end of said claim, one on each side of and 300 feet from the center end monuments, or stakes, making the claim in the form of a parallelogram.

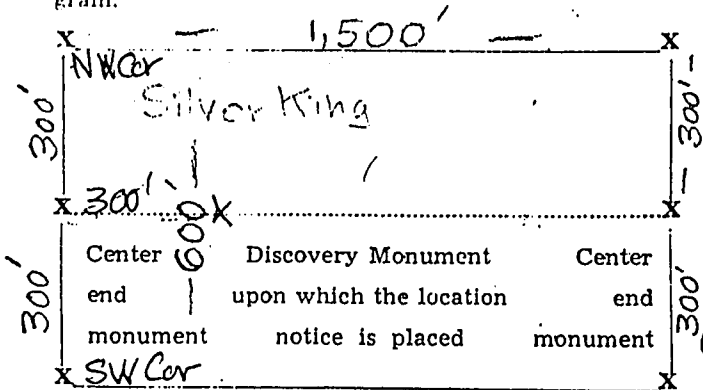

Ron Deen
Gary T. Deen
Joe Deen
Ronald Deen

RECEIVED
B.L.M. AZ STATE OFFICES
2003 JUN 11 A 11:03
PHOENIX, ARIZONA

ANC 358031

STATE OF ARIZONA, County of Pinal

ss.: Fee No. 2003-040452

I hereby certify that the within instrument was filed and recorded at request of
.....in Docket..... Page 3..... and indexed 35 Min.

Witness my hand and official seal the day and year aforesaid.

..... By.....
County Recorder Deputy Recorder.

See map attached

RECEIVED
BLM.
ARIZONA STATE OFFICE

2 27 PM '97

N

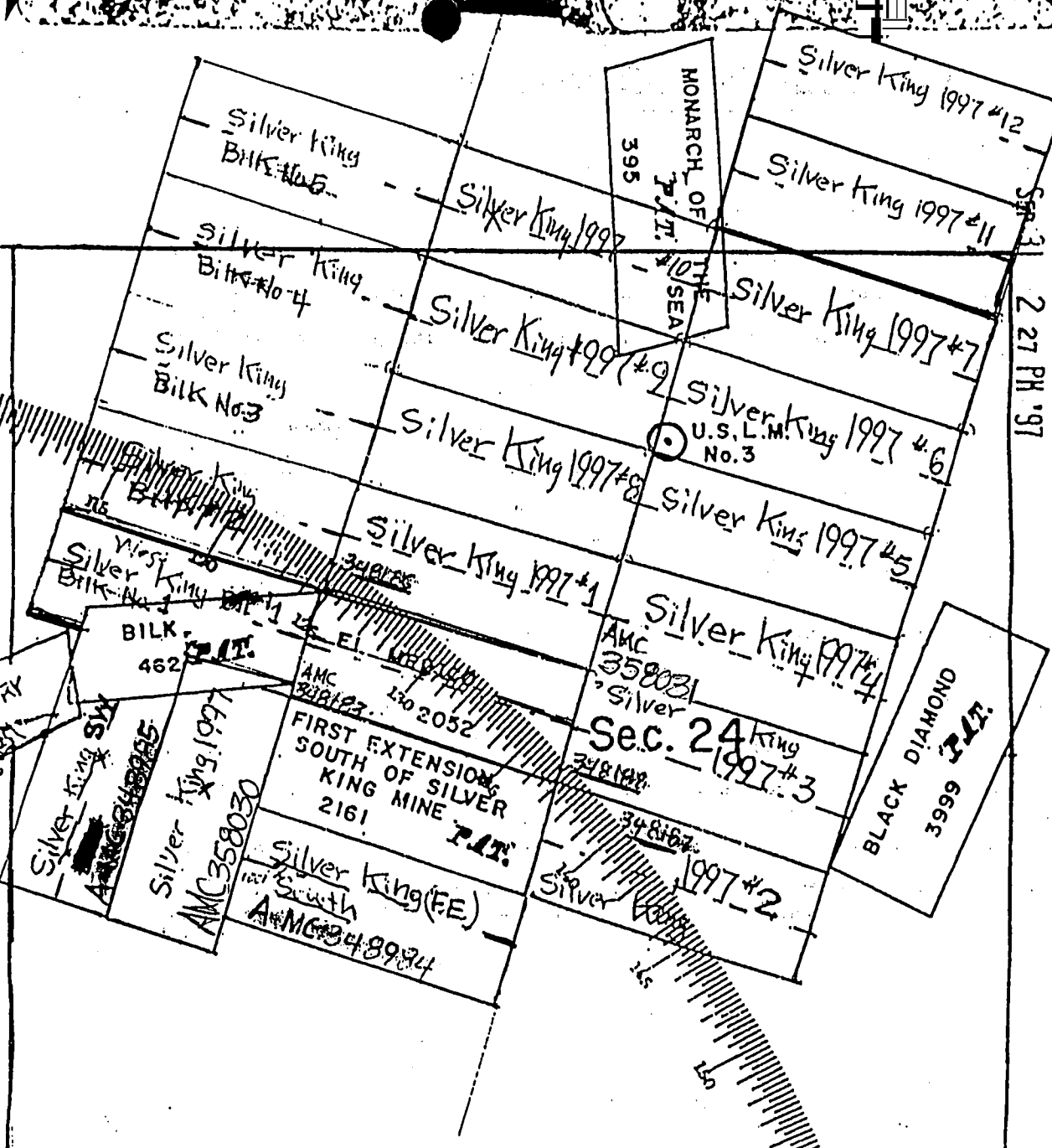

Section 24, Township 1S, Range 12E

Joe Deen
Ron Deen
Gary Deen
Ronald Deen, Sr.
56389 E. Simmons Way
Kearny, AZ 85237

Input Parameters for Geographic Report with Land

System Id = CR

Admin State = AZ

Geo State = AZ

Casetype begins with

Case Disp Txt = AUTHORIZED, EXPIRED, No Match, PENDING, REJECTED, RELINQUISHED, VOID, WITHDRAWN

Mer Twp Rng = 14 0010S 0120E 024

Mtrs =

Commodity =

Pending Org =

Section =

Total Rows Returned: 0

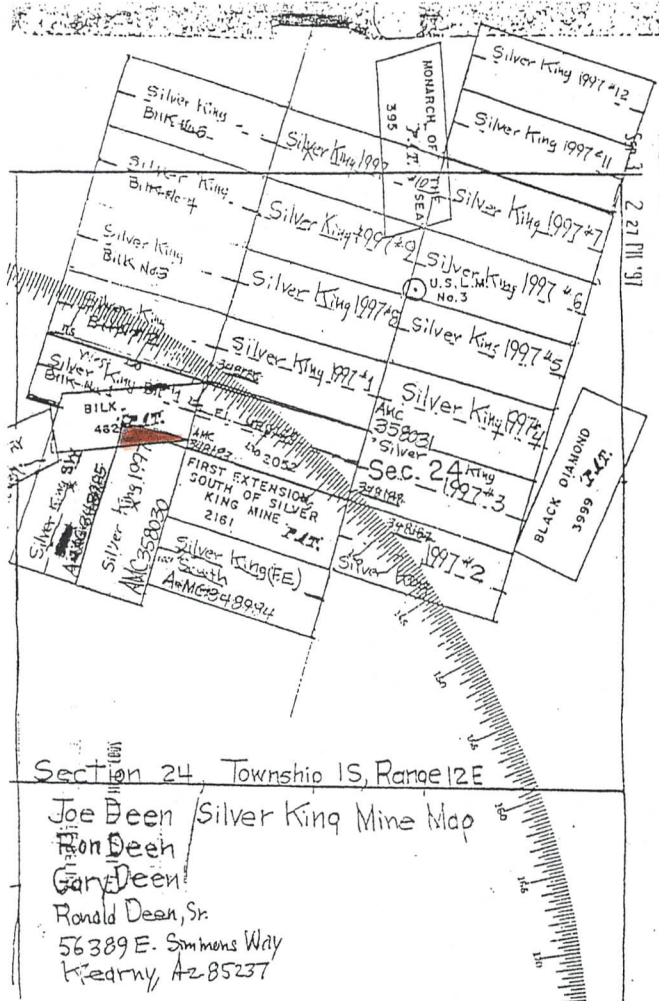

RECEIVED
 BLM
 ARIZONA STATE OFFICE
 2 27 11 91
 N

Section 24, Township 1S, Range 12E

Joe Deen
 Ron Deen
 Gary Deen
 Ronald Deen, Sr.
 56389 E. Simmons Way
 Kierdny, Az-85237

75015

United States Department of the Interior
BUREAU OF LAND MANAGEMENT
ARIZONA STATE OFFICE
222 North Central Avenue
Phoenix, Arizona 85004-2203

The enclosed serial register pages identify the serial numbers that have been assigned to your mining claim location notices. If any information is incorrect, please notify this office.

ADDITIONAL INFORMATION

ASSESSMENT YEAR: Begins at 12 noon September 1 through 12 noon the following September 1.

If the claim was located before September 1 and near the end of the assessment year, you must pay the \$135 plus an additional \$100 maintenance fee to cover the upcoming assessment year. If you qualify for a small miner's waiver, you may submit a Maintenance Fee Waiver Certification (waiver) rather than pay the \$100 for the assessment year. (Example: If the location date is August 28 and you file with BLM September 5, you must pay \$135 for the assessment year in which the claim is located and either pay an additional \$100 maintenance fee or file a waiver for the following year **at the same time**. If you do not qualify for a waiver, you must pay the additional \$100 maintenance fee.)

MAINTAINING CLAIMS: Either a \$100 Maintenance Fee or a Maintenance Fee Waiver Certification must be filed on or before September 1 each year, and is filed in advance for the upcoming year. There is no fee required for the waiver. If you file a waiver, for the first year, you must file a Notice of Intention to Hold (NOI) on or before the December 30 immediately following the filing of the waiver and you **MUST** file an Affidavit of Performance of Annual Work (POL) by December 30th of the following year and each year thereafter. Example: On September 1, 2002, you file a waiver for the 2003 assessment year. By December 30, 2002, you must file a NOI, AND by December 30, 2003, you **MUST** file a POL. BLM service charge is \$5 per claim to file a Notice of Intention to Hold or an Affidavit of Performance of Annual Work.

CHANGE OF ADDRESS: It is important to notify us of any change of address. Please list the claim name and serial number. There is no fee for a change of address.

AMENDMENTS: If a correction is required on the original location notice, an amended notice should be filed with the BLM and County Recorder. BLM service charge is \$5 per claim. Note: You cannot amend a mining claim to add additional acreage or locators, or to change the type of claim (i.e., lode to placer).

TRANSFER OF INTEREST: If there is a change of ownership, the notarized transfer document must be filed with BLM and the County Recorder. BLM service charge is \$5 per claim.

PRIOR TO OPERATION: Contact the BLM Field Office or Forest Service Office having jurisdiction over the land in which your claim is located pertaining to what type of work you are allowed to do and what steps are required, such as casual work, notice or plan of operations, and bond requirements.

5/25/04